



## Product Description



## Packing & Delivery



### Shipping Way

We have strong cooperation with DHL, FEDEX, TNT, UPS, EMS, Forwarder by SEA and By AIR You also can choose your own shipping forwarder.

#### Packaging

Magnetic Lock packaging: 1unit per box, 10pcs per carton,

Carton size : 26\*26\*10cm , Gross Weight :46kg. 50 cartons per pallet



- ACM Goldbridge 2
- ACM Goldbridge
- 



# STANDARD INSTALLATION STEPS

Professional guidance, Rest assured

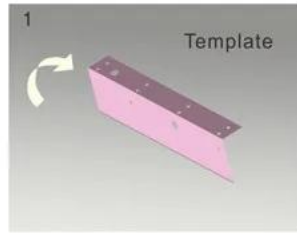

1 Fold the plate to 90° .

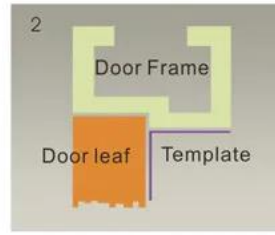

2 Close the door first, then place the upper side of template on door frame, while adjust the left side next to the door leaf.

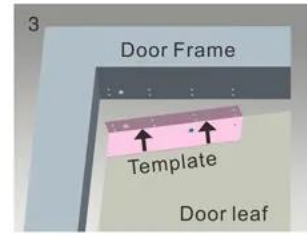

3 Mark screw positions of armature plate and magnetic lock on door leaf and door frame respectively.



4 Drill holes based on the marked positions.

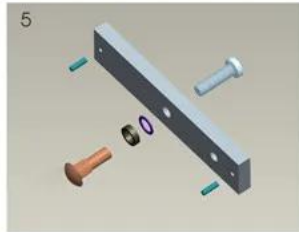

5 Make a combination based on the picture.

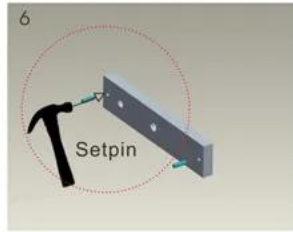

6 Strike the pin into the armature plate slightly (to avoid movement).

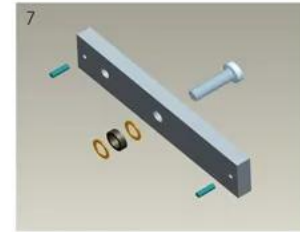

7 Make a combination based on the picture (add washer accordingly). The rubber ring must be added.

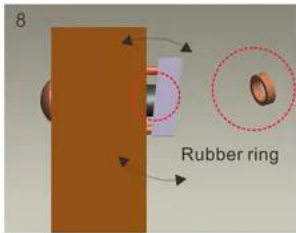

8 Place the rubber ring between armature plate and door leaf.



9 Use Allen key to remove the mounting plate from lock body.

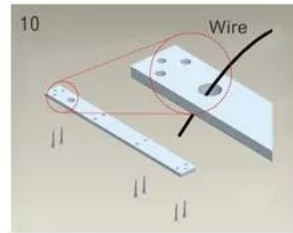

10 Fix the mounting plate on the door frame according to the holes drilled earlier.

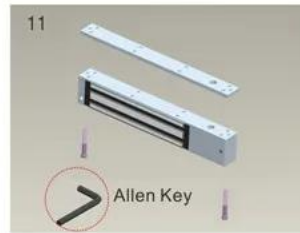

11 Use Allen key to screw the lock body on the mounting plate.

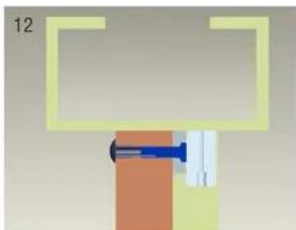

12 Close the door to test holding force. The angle between armature plate and magnetic lock can be adjusted by adding or reducing washers.

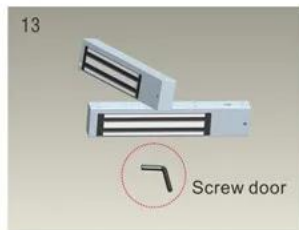

13 After all the appropriate procedures, the holding force can be maximized. Finally, fix the tamper screw.

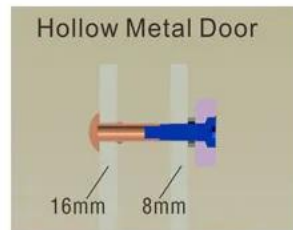

Hollow Metal Door  
Drill a hole  
Inside: Diameter is 8mm  
Outside: Diameter is 16mm

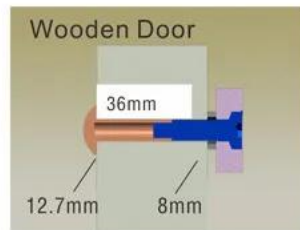

Wooden Door  
Drill a hole  
Inside: Diameter is 8mm  
Outside: Diameter is 12.7mm

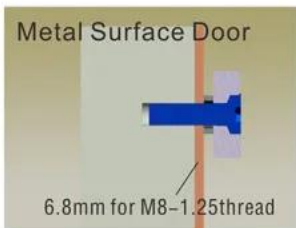

Metal Surface Door  
Inside: Drill a hole  
diameter is 8mm folding  
the plastic straight pin

## Notice:

Thickness of Door Leaf:

350LBS: 44mm

600LBS: 50mm

800LBS: 48mm

1200LBS: 46mm



□□□□□

□□□□  
□□□DHL□FEDEX□TNT□UPS□EMS□SEA□AIR□□□□□□□□□□□□  
□□□□□□□□□□□□

□□  
□□□□□□□□1□□□□6□□  
□□□□□35 \* 30 \* 20cm□□□□□24kg□□□□□50□



## You may need



### ACM-Y280N

□□□□□□□□280□□/ 600□□□□□□□□□□□□  
□□□□□□□□

### ACM-Y180

□□□□□□□□180kg / 300lbs□□2□□□□□□□□□□

### ACM-Y280

280□□□□600□□□□□□□□□□□□□□□□□□□  
□□



### ACM-Y280-L

L□□□□□280 kg / 350 kg□□□

### ACM-Y180ZL

ZL□□□□180kg / 300lbs□□□

### ACM-Y280-ZL

ZL□□□□280Kg / 350Kg□□□

□□□□□

1□□□□□□24□□□□□

8000 DHL FEDEX TNT UPS EMS SEA AIR

1111

RFID / NFC / RFID / RFID