

A photograph of two aluminum extrusion profiles. One profile is lying horizontally, and a second profile is placed vertically across its T-slot. The vertical profile has a brushed metal finish, while the horizontal one is a standard anodized aluminum. Both profiles feature a series of mounting holes along their length.

ACM 20121130-R27474

□□□□ ACM □□□□□ Collinear Load Test 280kg /600pounds

□□□ 12 □ 24 VDC□□□□

□□□□□□□□ 12VDC

□□□□□ NO/NC/COM

MOV □□□□□□□□

□□□□□

□□□□□□□□□□□□□□

□□□□□□□□

□□□□□□□□□□□□

- ✓ Thick aluminum alloy
- ✓ strong and sturdy
- ✓ Electronically
- ✓ controlled magnetic force
Anti-theft

Magnetic lock

280kg

Alloy Lock Body Excellent Craftsmanship



DETAILS

01

Alloy lock body

The lock body is made of high-quality aluminum alloy. Robust and classic design. Fine workmanship made of aluminum alloy material, High strength and durability.



02

Anti-theft device

The access control magnetic lock is equipped with a screw wrench for security. When the magnetic lock is installed outdoors, in the locked state, people outside will also remove it for safety and peace of mind.

03

Suction patch

Using precision components,
each magnetic lock is
Tested by precision instruments,
good performance,
Stable quality and guaranteed
after sales.



04

Stable suction

This magnetic lock has a pull-
ing force of 280kg, which is
stable and durable, safe and
reliable.

06

Lock indicator

Under normal conditions,
the red light is off
Red light on means locked



Magnetic lock external opening installation step diagram

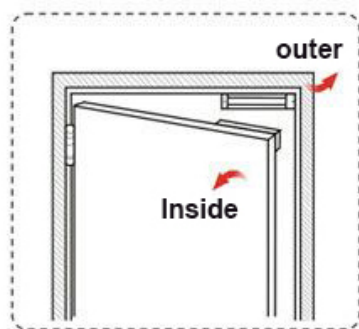

Opening method →

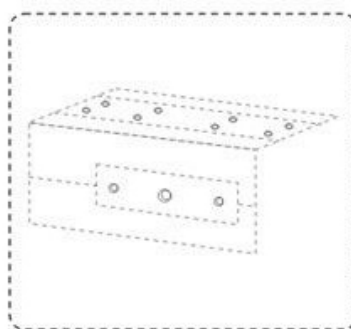

1. Standard hole bitmap

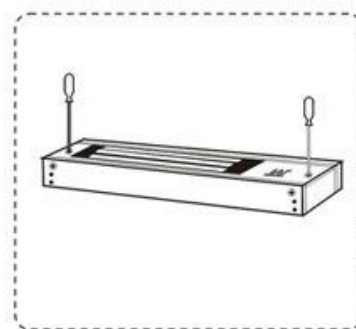

2. Use a screwdriver to unscrew the anti-removal screws.



3. Separate the lock body and the connecting plate with a hexagonal key.

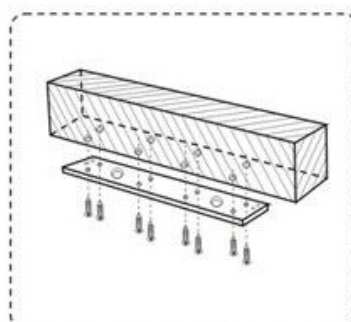

4. Find the appropriate position and attach the connecting plate to the door frame.



5. Secure the lock body and connecting plate with a hexagonal key.

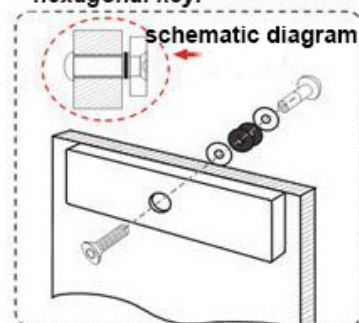

6. Install the attachment plate, first pad the gasket and rubber ring, and arrange them in order.

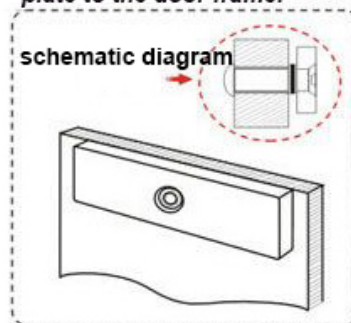

7. Fix it with screws, the effect is as shown in the figure.

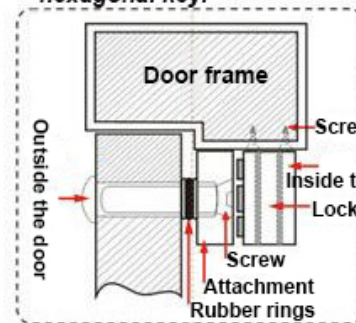

8. Final effect diagram.

□□
□□□;□□□

□□
□□□
□□□□□□□
□□□□□□□

□□□□□□
□□□□□
□□□□□
□□□□□
□□□□□ x □ x □□

□□
□□
□

□□□□□
280 □□□600 □□

□□□□LED
NO,NC,COM

12/24VDC
12V/500mA 24V/250mA

□□

250Lx48Wx25H(□□)

180L*38W*11H(mm)

2.0mm

Packing & Delivery



Shipping Way

We have strong cooperation with DHL, FEDEX, TNT, UPS, EMS, Forwarder by SEA and By AIR You also can choose your own shipping forwarder.

Packaging

Magnetic Lock packaging: 1unit per box, 10pcs per carton,

Carton size : 26*26*10cm , Gross Weight :46kg. 50 cartons per pallet

RFID UHF R2000 UHF OEM RFID uhf rfid 2.4G rfid EM 125KHZ RFID FCC CE ROHS

RFID



SHENZHEN GOLDBRIDGE INDUSTRIAL CO.,LTD

Factory Wholesale with **20% Discount OFF** - **RFID Cards**,
RFID Reader, **Access Control** , **Locks**, **Exit Button**



125Khz EM4100 Proximity Card (ACM-EMI-S)	Mifare 1K ISO Blank Card (ACM-MF1)	125Khz Clamshell Thick Card (ACM-EMC-I)	125Khz EM4100 rfid Key fob (ACM-ABS003)	125Khz EM Silicon Wristband (ACM-W003/005)
USB Desktop Reader (ACM-08M)	Access control rfid reader (ACM-302)	Access control rfid reader (ACM28A)	Keypad access control reader (ACM-305)	Access control rfid reader (ACM-26)
Metal Touch Screen Keypad IP65 Access Controller (ACM-A10)	Touch Keypad Access Controller (ACM225)	Metal Keypad Access controller (ACM208A)	Keypad standalone RFID Access Controller (ACM223)	Metal Keypad Access Controller (ACM209A)
2-6Meter UHF Long range rfid reader (ACM813A)	6-12Meter UHF Reader (ACM802A)	10-20Meter UHF Reader (ACM819A)	8-12Meter UHF Reader (ACM803A)	UHF USB Desktop Encode Reader /Writer with SDK (ACM-217UHF)
60kg/120lbs EM Lock (ACM-Y60)	180kg/300lbs LED EM Lock (ACM-Y180)	280kg/600lbs Timer /LED EM Lock (ACM-Y280-5PIN)	Long type Fail safe Electric Strike (ACM-Y132)	Drop bolt Deadbolt Lock, Power to unlock (ACM-Y100)
Yale Waterproof Electric RIM Lock (ACM-Y045)	No touch Door Release Exit Button (ACM-K2A/K6A)	Dual function : Power Supply+exit button (Y802A)	QR CODE Scanner rfid Reader	Passport ID Scanner (ACM901)

SHENZHEN GOLDBRIDGE INDUSTRIAL CO.,LTD

Whatsapp: +86-14554918707 , E-mail: lilyjiang_06@163.com, sales@goldbridgesz.com ; www.goldbridgesz.com

For More Products Price List and informations , Please contact our sales at sales@goldbridgesz.com, thank you !

- 280 600
- 12 24 VDC
- 12VDC
- MOV
-
- LED
- NO / NC / COM
- NO / NC / COM
-
-
-
-
- CE MA
- OEM / ODM



000000 LED 000000000000 000000000000 .00000000
 ACM-Y28000000 PCB000000000000 12v 0 24v 0000 7 00000000000000 PCB 00

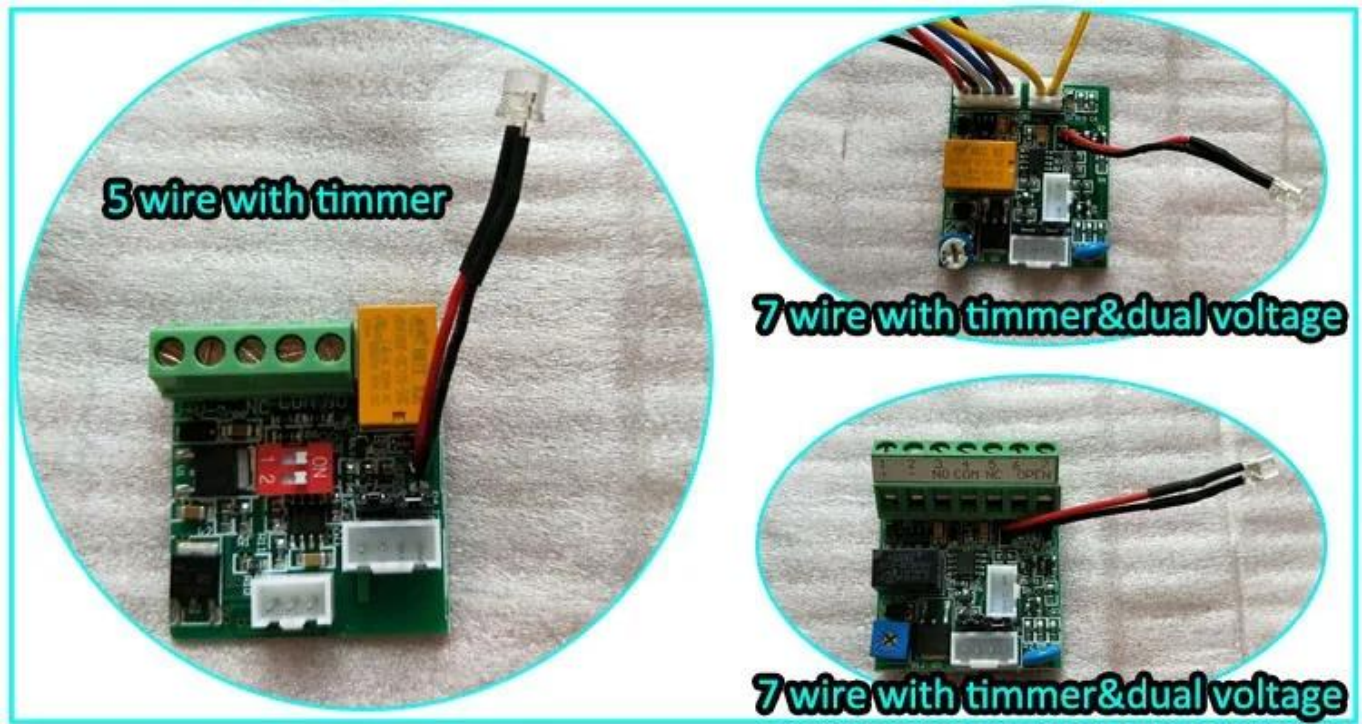

□□□□

- □□□□ ACM Goldbridge □□□□□□ 2 □□□□
- □□□□□□□□ ACM Goldbridge □□□□□□□□
- □□□□□□□□□□□□□□□□

□□□

STANDARD INSTALLATION STEPS

Professional guidance, Rest assured

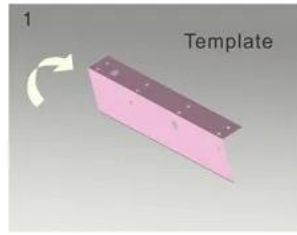

1 Fold the plate to 90° .

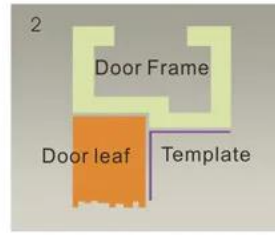

2 Close the door first, then place the upper side of template on door frame, while adjust the left side next to the door leaf.

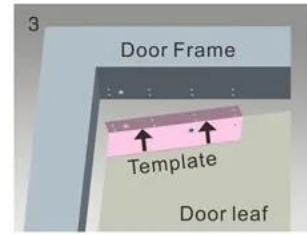

3 Mark screw positions of armature plate and magnetic lock on door leaf and door frame respectively.



4 Drill holes based on the marked positions.

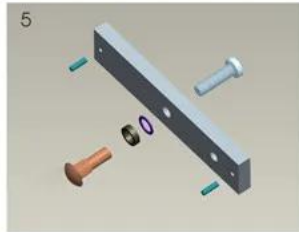

5 Make a combination based on the picture.

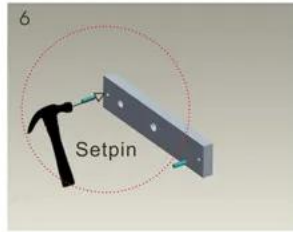

6 Strike the pin into the armature plate slightly (to avoid movement).

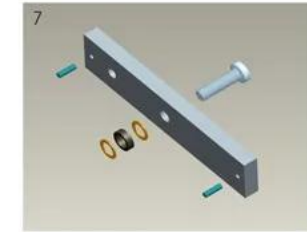

7 Make a combination based on the picture (add washer accordingly). The rubber ring must be added.

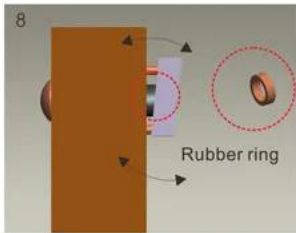

8 Place the rubber ring between armature plate and door leaf.



9 Use Allen key to remove the mounting plate from lock body.

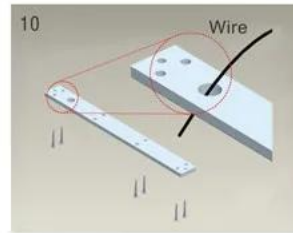

10 Fix the mounting plate on the door frame according to the holes drilled earlier.

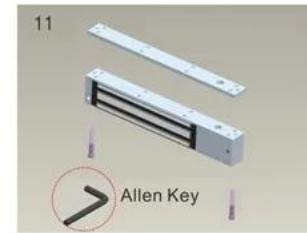

11 Use Allen key to screw the lock body on the mounting plate.

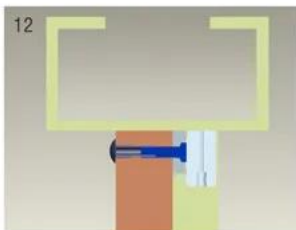

12 Close the door to test holding force. The angle between armature plate and magnetic lock can be adjusted by adding or reducing washers.

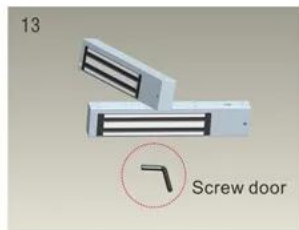

13 After all the appropriate procedures, the holding force can be maximized. Finally, fix the tamper screw.

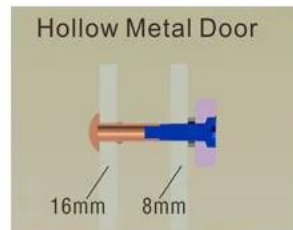

Drill a hole
Inside: Diameter is 8mm
Outside: Diameter is 16mm

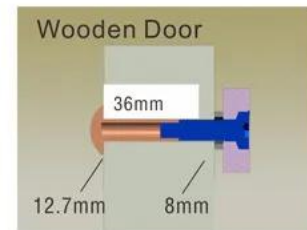

Drill a hole
Inside: Diameter is 8mm
Outside: Diameter is 12.7mm

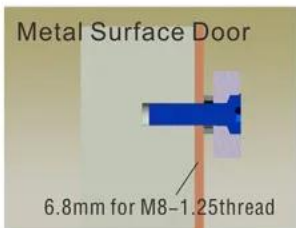

Inside: Drill a hole
diameter is 8mm folding
the plastic straight pin

Notice:

Thickness of Door Leaf:

350LBS: 44mm

600LBS: 50mm

800LBS: 48mm

1200LBS: 46mm

□□□□

□□□□

□□□ DHL, FEDEX, TNT, UPS, EMS, Forwarders by SEA and By AIR □□□□□□

□□□□□□□□□□□□

□□

□□□□□□□□ 1 □□□□ 12 □□

□□□□□ 54.3 * 13.5 * 19.3□□□□□□25 □□ 50 □/□□





ACM-Y280N

□□□□ (280kgs / 600lbs) □□□□□□□□□□
□□□□ | □□□

ACM-Y180

□□□□180 □□/300 □□□□ 2 □□□□□□□

ACM-Y280

280 □□□600 □□□□□□□□□□□□□□□□□□
□□□



ACM-Y350

350mm x 80mm 304 stainless steel
 304 stainless steel

ACM-Y500

500kgs (1000lbs) 304 stainless steel
 304 stainless steel

ACM-Y280-W

280mm x 60mm 304 stainless steel
 304 stainless steel

You may need



ACM-Y100S

Electric Bolt □ (5PIN) □□□□□□□□□□□□

ACM-Y130

□□□□NC / NO□□□□
 □□□□110x28x31mm

ACM-Y066

□□□□□□□□□□
 Lock

1. 24

2.

3, OEM / ODM

4.

5.

1),

2),

3), 2-3

6 : 1 ~ 5 7 ~ 30

T / T Western Union Paypal

8 DHL FEDEX TNT UPS EMS SEA Forwarders By AIR

20⁺ YEARS EXPERIENCE OEM & ODM

ACCESS CONTROL SYSTEMS ONE STOP SOLUTION PROVIDER

Goldbridge is Top 10 China Manufacture On Alibaba, Specializes In Provide Kinds Of RFID/NFC Cards, FID Tags, RFID Card Reader, UHF Reader, Access Control System, Electromagnetic Locks, etc Since 1999



Customized
Services



Quality
Assurance



Fast
Delivery



Best After-
Sales Service

OUR FACTORY



Access Control and RFID Reader Production Line:

- Monthly production quantity is up to 50,000pcs, We are Provides OEM&ODM services including product research and development, LOGO printing, customized etc



Door Lock Production Line

Electromagnetic lock & Smart Door Lock Production Line :

- Monthly production quantity is up to 100,000pcs,
- Our factory is built with modern manufacture environment, facilities, equipment and professional operation technicians.
- Goldbridge Provides OEM&ODM services including product research and development, LOGO printing and product box customized.



RFID & NFC Cards & Tags Production Line :

- RFID Tag, Wristband, Keyfob: 11,000,000pcs (monthly output)
- Four Production Lines For Smart Card, PVC Card, Prelam Sheet: 20,000,000pcs (monthly output)
- Goldbridge Provides OEM&ODM services for LOGO printing, development, customized.

ADVANTAGE



WHY CHOOSE US?

- FAST DELIVERY** Faster delivery by air by express. (DHL, UPS or Fedex)
- LONG HISTORY** 20 years experience in RFID & Access Control industry
- OEM ACCEPTABLE** 20 years OEM&ODM experience for 1000 + VIP client from US and Europe
- HIGH QUALITY** Design and manufacture high quality products with 30 R&D; engineers.

APPLICATION

Bus, supermarket, school, government, hospital, factory



CERTIFICATE



