

## Product Description



## 12V DC Mini Solenoid Lock 60KG magnetic fail safe lock for Glass/Wooden/Fire Door Access Control

Collinear Load Test 60kg,120pounds.

MOV Provides Reverse Current Protection.

## Anti-Residual Magneism Designed.

High Strength Material,Anodized Aluminum Housing.

Design with no Mechanical Bolt.

Increase the holding Force,Dual Insulative Hosing.

CE Certificate by European Union,MA

Certificate by China Public Security Office.

## Product Advantage

1. Passed 100lbs super static linear tension tests.
2. Anti-residual magnetic design, keep constant tension.
3. Built-in reverse current protection device (MOV), performance stability ,safety coefficient is higher.
4. Wear materials, durable.
5. Electromagnetic suction work completely, there is no mechanical failure.
6. Shell with high strength alloy material, anode hardening treatment.
7. Lock body with double insulation treatment.

Detailed Images , OEM/ODM available

## Mini Single Door Magnetic Lock

### Stable Holding Force

magnetic locks  
have 60kg(100 lbs) linear pulling force.



### Aluminum Shell

Shell with high strength alloy material,  
anode hardening treatment.



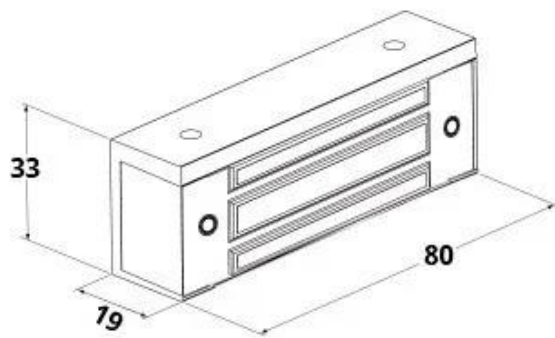

**NE-60**  
**Lock Size: 80L\*33W\*19H(mm)**

- Input voltage:DC12V,or DC24 (can be customized)
- Holding Force: 60Kgs(120Lbs)
- Suitable for: showcase, cabinet door etc.
- Finishes for Shell: Anodized aluminum
- Finishes for Magnetic: Zinc
- Finishes for Armature: Zinc

## Product Application

## Double Insulation

Lock body with double insulation treatment.

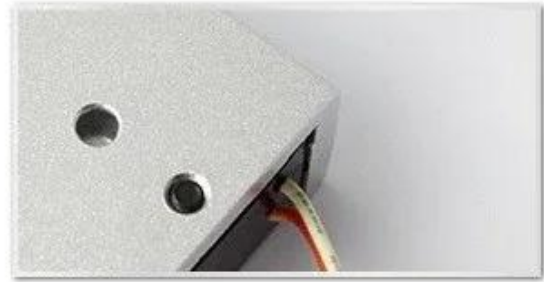

## special Used to Small Cabinet Door

Saves time and power when installation.



Instalation Diagram

# STANDARD INSTALLATION STEPS

Professional guidance, Rest assured

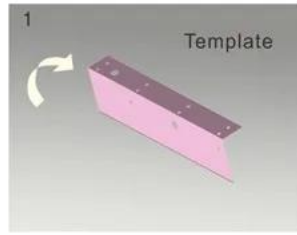
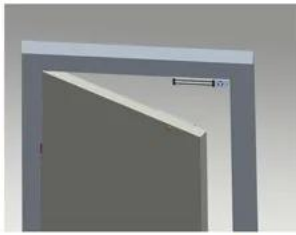

1 Fold the plate to 90° .

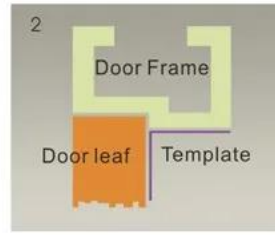

2 Close the door first, then place the upper side of template on door frame, while adjust the left side next to the door leaf.

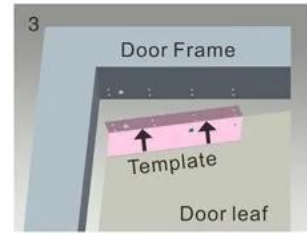

3 Mark screw positions of armature plate and magnetic lock on door leaf and door frame respectively.



4 Drill holes based on the marked positions.

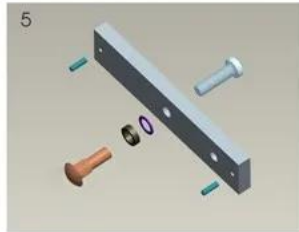

5 Make a combination based on the picture.

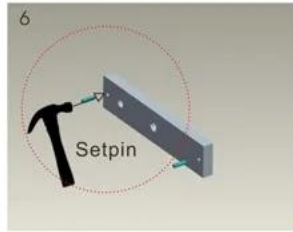

6 Strike the pin into the armature plate slightly (to avoid movement).

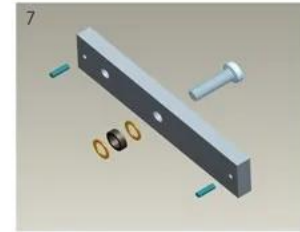

7 Make a combination based on the picture (add washer accordingly). The rubber ring must be added.

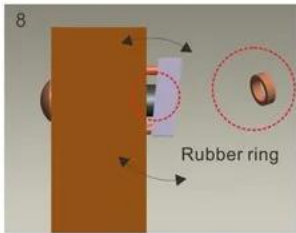

8 Place the rubber ring between armature plate and door leaf.



9 Use Allen key to remove the mounting plate from lock body.

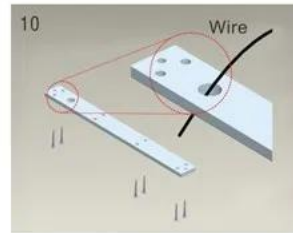

10 Fix the mounting plate on the door frame according to the holes drilled earlier.



11 Use Allen key to screw the lock body on the mounting plate.

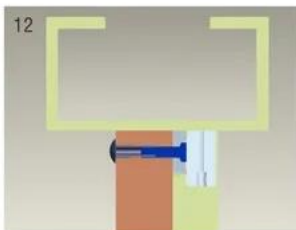

12 Close the door to test holding force. The angle between armature plate and magnetic lock can be adjusted by adding or reducing washers.



13 After all the appropriate procedures, the holding force can be maximized. Finally, fix the tamper screw.

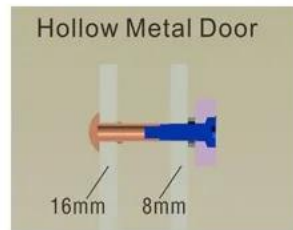

Hollow Metal Door  
Drill a hole  
Inside: Diameter is 8mm  
Outside: Diameter is 16mm

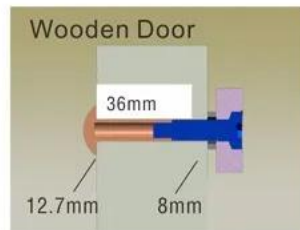

Wooden Door  
Drill a hole  
Inside: Diameter is 8mm  
Outside: Diameter is 12.7mm

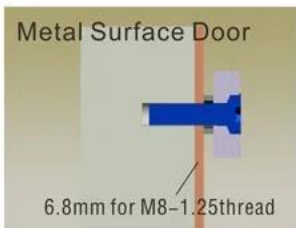

Metal Surface Door  
6.8mm for M8-1.25thread  
Inside: Drill a hole diameter is 8mm folding the plastic straight pin

## Notice:

Thickness of Door Leaf:

350LBS: 44mm

600LBS: 50mm

800LBS: 48mm

1200LBS: 46mm

## Related Products

[Click here to order and have your FREE SAMPLE in 3 days!!!](#)

We are professional comprehensive security access control products supplier with 20 years experience, we make sure to offer the best solution of access control system solution! So, send your inquiry details in the below, click "Send" now!

We are looking forward to forming successful business relationships with new clients around the world in the future.



### **ACM-280N**

Backplate magnetic lock  
(280kgs/600lbs) Suitable For: Wooden  
Door, Glass Door, Metal Door, Fire|  
Proof Door



### **ACM-Y180**

Surface mounted (180kg/300lbs)  
magnetic lock 2Bolts Fail safe.Suitable  
For: Wooden Door, Glass Door, Metal  
Door, Fire Proof Door.



### **ACM-Y280**

280kg(600lbs) Single Door magnetic Lock Suitable For: Wooden Door, Glass Door, Metal Door, Fire Proof Door.



### **ACM-Y350**

Single Door Magnetic Lock  
350kgs(800lbs) Suitable For: Wooden Door, Glass Door, Metal Door, Fire Proof Door.



### **ACM-Y500**

Single Door Magnetic Lock  
500kgs(1000lbs) Suitable For: Wooden Door, Glass Door, Metal Door, Fire

Proof Door.



### **ACM-Y280-W**

Single Door Magnetic Lock  
280kgs(600lbs) Waterproof.Suitable  
For: Wooden Door, Glass Door, Metal  
Door, Fire Proof Door.



## You May Need

### Complete Door Access Control Solution Provider

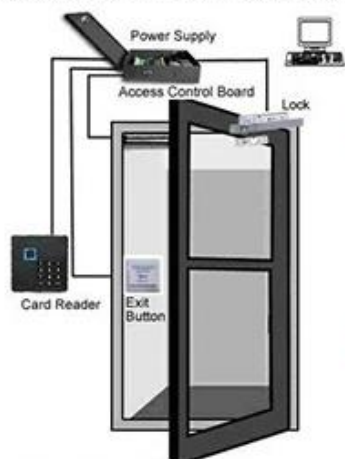

**RFID Card**



**RFID Key fob**



**RFID Wristband**



**RFID Reader**



**Long Distance  
UHF Reader**



**Access Control  
Reader**



**Biometric Controller**



**RFID Controller**



**Door EM Lock**

## ABOUT GOLDBRIDGE

As a one of leading manufacturer and exporter of RFID products in China, We have been in this field for 20 years already. We have rich production and exportation experience on RFID products. Our strength products are: rfid card, rfid Keyfob, rfid wristband, rfid tag and various rfid reader. We are also the access control solution provider.

[MORE >>](#)



## ABOUT OUR FACTORY

Established in 1999, Shenzhen Goldbridge has witnessed the technological innovation from rfid card to rfid tag, the overall change of market products in the past 20 years, and registered "Shenzhen Goldbridge Industrial Co., Ltd." in 1999.

At present, Goldbridge has developed into a National High-Tech Enterprise, which is specialized in the integration of production, market and research. Starting from the PVC cards and RFID cards factory with only 66 workers, Goldbridge has accomplished the successful transition from traditional manufacturing industry to IOT technology enterprise (RFID technology development).



With the accumulation of dozens of software copyrights and utility new inventions and patents, Goldbridge has been rewarded as "National High-Tech Enterprise", "Shenzhen High-Tech Enterprise", and has become an integrated enterprise which focuses on research, production and market. Meanwhile, by adopting the "Military + School + Family" corporate culture concept, accompanied by the continuous innovation of business model and marketing model, plus the B2B, B2C platform and excellent sales team, Goldbridge sells its products all over the world.





## Honers & Certificates

