

00 00



**12V** 00 00 00 00 00 00 00 00 00 00 **Rfid** 0000 00 00 00

NC 00 - (0000 0000 00 00), 00 0000 00

LED 00 0000 000000

0000 00 280kg(600lbs)

00 00 0000: 0000 00 0, 0000 0, 00 0, 00000 00 0

ACM 00 00 000000 00 00000000. ACM 0000 00 20121130-R27474, 00 00

□□ □□□ □□□ □□ □□□ □□ ACM □□ □□□ □□ □□□□□□□ □□□□□. □□ □□ □□ □□□  
280kg /600□□□  
□□ □□ 12 □□ 24 VDC(□□)  
□□□□ □□ □□□ 12VDC□□□.  
□□ □□: NO/NC/COM  
MOV□ □□□ □□ □□□ □□□□□.  
□□ □□ □□ □□  
□□□ □□, □□□□□□ □□□□ □□□  
□□□ □□□ □□ □□  
□□□ □□, □□ □□ □□□

- ✓ Thick aluminum alloy
- ✓ strong and sturdy
- ✓ Electronically
- ✓ controlled magnetic force  
Anti-theft

Magnetic lock

280kg

## Alloy Lock Body Excellent Craftsmanship



# DETAILS

01

## Alloy lock body

---

The lock body is made of high-quality aluminum alloy. Robust and classic design. Fine workmanship made of aluminum alloy material, High strength and durability.



02

## Anti-theft device

---

The access control magnetic lock is equipped with a screw wrench for security. When the magnetic lock is installed outdoors, in the locked state, people outside will also remove it for safety and peace of mind.

**03**

## Suction patch

---

Using precision components,  
each magnetic lock is  
Tested by precision instruments,  
good performance,  
Stable quality and guaranteed  
after sales.

**04**

## Stable suction

---

This magnetic lock has a pull-  
ing force of 280kg, which is  
stable and durable, safe and  
reliable.

**06**

## Lock indicator

---

Under normal conditions,  
the red light is off  
Red light on means locked



# Magnetic lock external opening installation step diagram

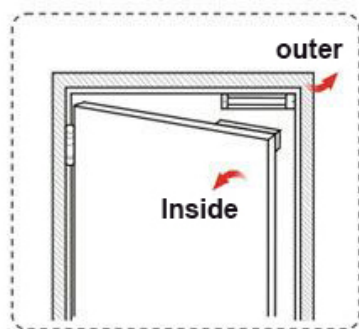

Opening method →

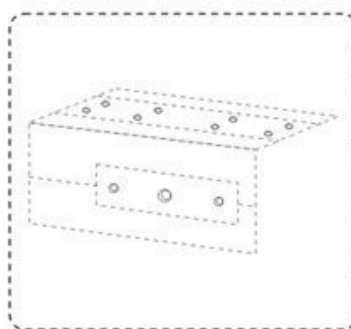

1. Standard hole bitmap

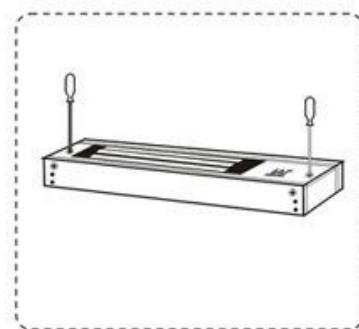

2. Use a screwdriver to unscrew the anti-removal screws.



3. Separate the lock body and the connecting plate with a hexagonal key.

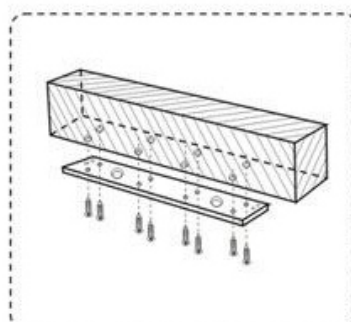

4. Find the appropriate position and attach the connecting plate to the door frame.

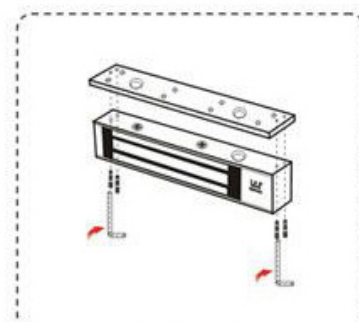

5. Secure the lock body and connecting plate with a hexagonal key.

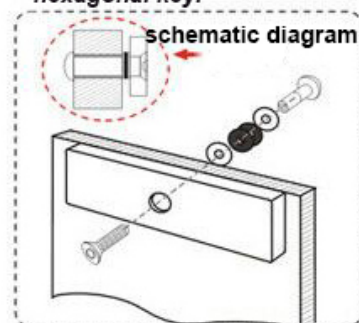

6. Install the attachment plate, first pad the gasket and rubber ring, and arrange them in order.

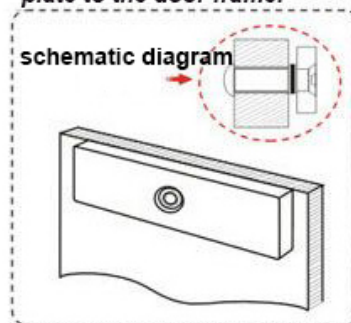

7. Fix it with screws, the effect is as shown in the figure.

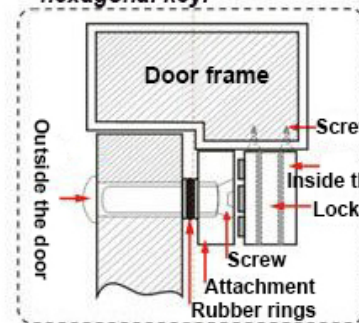

8. Final effect diagram.

□□  
□□□

□□  
□□□  
□□ □□ □□□  
□□ □□ □□  
□□ □□ □□  
□□ □□

□□□ □□ □□  
□□ □□(L x W x D)

□  
□□  
□□  
CE,  
280kg(600□□□)  
□□ □ □□, □□ □□ LED  
NO, NC, COM  
12/24VDC  
12V/500mA 24V/250mA  
□□ □□  
250Lx48Wx25H(mm)

□□□ □□□□ □□(L x W x D) 180L\*38W\*11H(mm)

□□(kg)

2.0kg

## Packing & Delivery



## Shipping Way

We have strong cooperation with DHL, FEDEX, TNT, UPS, EMS, Forwarder by SEA and By AIR You also can choose your own shipping forwarder.

### Packaging

Magnetic Lock packaging: 1unit per box, 10pcs per carton,

Carton size : 26\*26\*10cm , Gross Weight :46kg. 50 cartons per pallet

Shenzhen Goldbridge IOT RFID 产品 研发团队 R&D 团队 专注于 RFID 产品的研发和生产。UHF 产品 包括 UHF 产品, UHF R2000 产品, UHF OEM 产品, RFID 产品, uhf rfid 产品, 2.4G rfid 产品, EM 125KHZ 产品, 以及 RFID 产品。产品符合 FCC, CE 和 ROHS 标准。

□□ □□



# SHENZHEN GOLDBRIDGE INDUSTRIAL CO.,LTD

Factory Wholesale with **20% Discount OFF** - **RFID Cards**,  
**RFID Reader**, **Access Control** , **Locks**, **Exit Button**



125Khz EM4100 Proximity Card (ACM-EMI-S)	Mifare 1K ISO Blank Card (ACM-MF1)	125Khz Clamshell Thick Card (ACM-EMC-I)	125Khz EM4100 rfid Key fob (ACM-ABS003)	125Khz EM Silicon Wristband (ACM-W003/005)
USB Desktop Reader (ACM-08M)	Access control rfid reader (ACM-302)	Access control rfid reader (ACM28A)	Keypad access control reader (ACM-305)	Access control rfid reader (ACM-26)
Metal Touch Screen Keypad IP65 Access Controller (ACM-A10)	Touch Keypad Access Controller (ACM225)	Metal Keypad Access controller (ACM208A)	Keypad standalone RFID Access Controller (ACM223)	Metal Keypad Access Controller (ACM209A)
2-6Meter UHF Long range rfid reader (ACM813A)	6-12Meter UHF Reader (ACM802A)	10-20Meter UHF Reader (ACM819A)	8-12Meter UHF Reader (ACM803A)	UHF USB Desktop Encode Reader /Writer with SDK (ACM-217UHF)
60kg/120lbs EM Lock (ACM-Y60)	180kg/300lbs LED EM Lock (ACM-Y180)	280kg/600lbs Timer /LED EM Lock (ACM-Y280-5PIN)	Long type Fail safe Electric Strike (ACM-Y132)	Drop bolt Deadbolt Lock, Power to unlock (ACM-Y100)
Yale Waterproof Electric RIM Lock (ACM-Y045)	No touch Door Release Exit Button (ACM-K2A/K6A)	Dual function : Power Supply+exit button (Y802A)	QR CODE Scanner rfid Reader	Passport ID Scanner (ACM901)

## SHENZHEN GOLDBRIDGE INDUSTRIAL CO.,LTD

Whatsapp: +86-14554918707 , E-mail: lilyjiang\_06@163.com, sales@goldbridgesz.com ; www.goldbridgesz.com

For More Products Price List and informations , Please contact our sales at sales@goldbridgesz.com, thank you !

## 產品特點

- 重量 280kg, 600mm.
- 12 或 24 VDC(選).
- 12VDC 選.
- MOV 保護電路.
- 紅, 黃, 綠, 藍 LED 選.
- LED 亮度 10000lm.
- 開關 (NO / NC / COM)
- 開關 (NO / NC / COM)
- 開關 10A.
- 開關 10A, 1000VAC 1000V.
- 開關 10A.
- 開關 10A, 10A 10A.
- 開關 CE 認證, 10A 10A MA 認證
- 開關, OEM / ODM 認證



ACM-Y280 LED 亮度 10000lm. 10A 10A, 10A 10A . 10A 10A 10A 10A.  
ACM-Y280 10A 10A 10A. PCB 10A 10A 10A 10A. 12v 24v 10A 10A 70 10A 10A 10A 10A. 10A 10A

□ □□ PCB □□□□□.

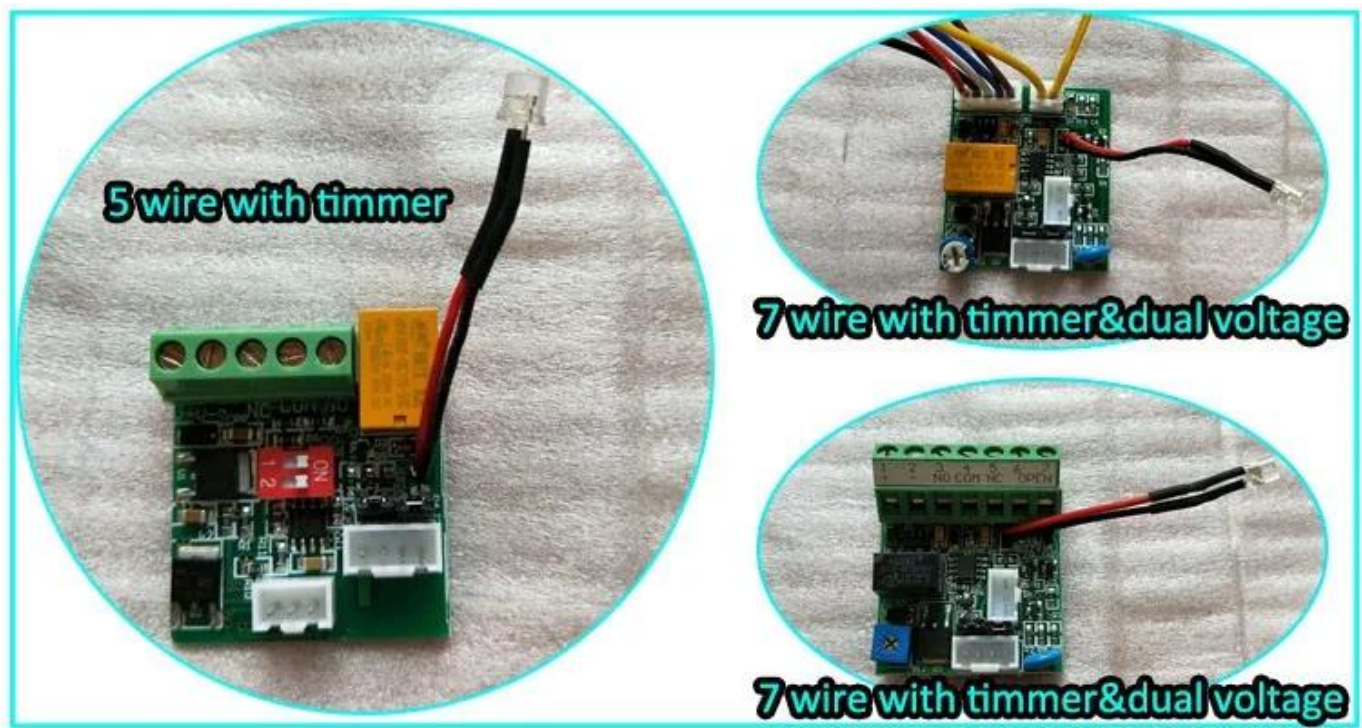

□□ □□

- □□ □□ ACM Goldbridge□ □□ □□ □□ 2□ □□ □□□□□.
- □□□ ACM Goldbridge□ □□ □ □□ □□□□□.
- □□□ □□□ □□□ □□□□□□□.

□□□

# STANDARD INSTALLATION STEPS

Professional guidance, Rest assured

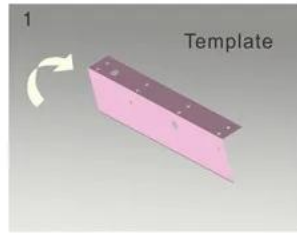

1 Fold the plate to 90° .

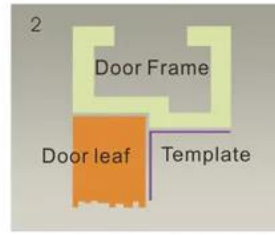

2 Close the door first, then place the upper side of template on door frame, while adjust the left side next to the door leaf.

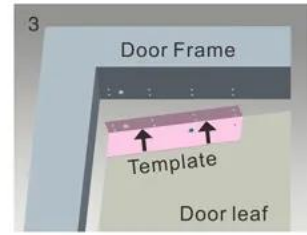

3 Mark screw positions of armature plate and magnetic lock on door leaf and door frame respectively.



4 Drill holes based on the marked positions.

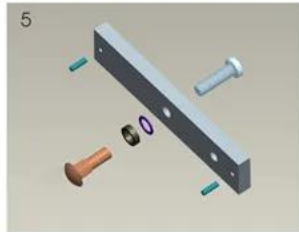

5 Make a combination based on the picture.

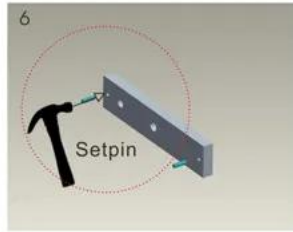

6 Strike the pin into the armature plate slightly (to avoid movement).

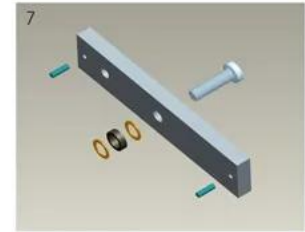

7 Make a combination based on the picture (add washer accordingly). The rubber ring must be added.

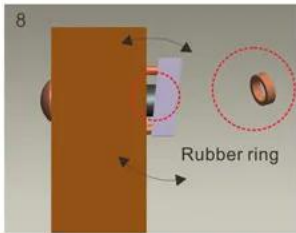

8 Place the rubber ring between armature plate and door leaf.



9 Use Allen key to remove the mounting plate from lock body.

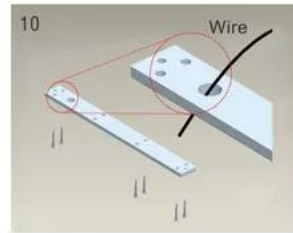

10 Fix the mounting plate on the door frame according to the holes drilled earlier.

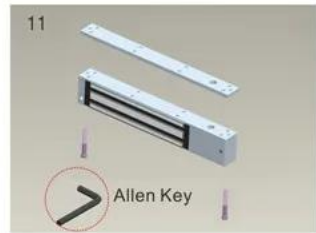

11 Use Allen key to screw the lock body on the mounting plate.

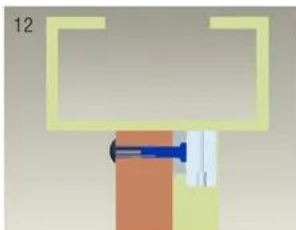

12 Close the door to test holding force. The angle between armature plate and magnetic lock can be adjusted by adding or reducing washers.

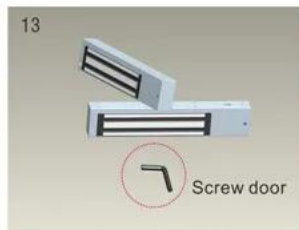

13 After all the appropriate procedures, the holding force can be maximized. Finally, fix the tamper screw.

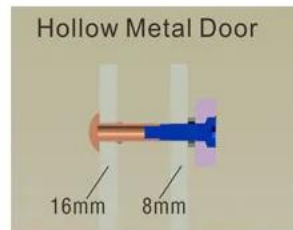

Hollow Metal Door  
Drill a hole  
Inside: Diameter is 8mm  
Outside: Diameter is 16mm

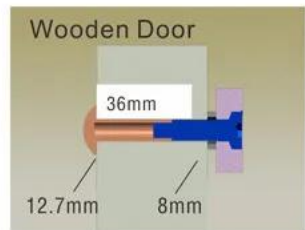

Wooden Door  
Drill a hole  
Inside: Diameter is 8mm  
Outside: Diameter is 12.7mm

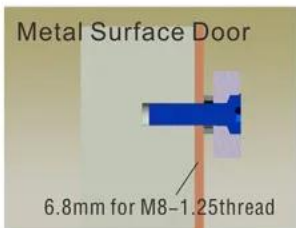

Metal Surface Door  
Inside: Drill a hole  
diameter is 8mm folding  
the plastic straight pin

## Notice:

Thickness of Door Leaf:

350LBS: 44mm

600LBS: 50mm

800LBS: 48mm

1200LBS: 46mm

□□ □ □□

□□ □□

□□□ DHL, FEDEX, TNT, UPS, EMS, SEA □ By AIR □ □□□ □□ □□ □□□□.  
□□□ □□ □□□□□ □□□ □ □□□□.

□□

□□□ □□: □□ □ 1□ □□, □□ □ 12pcs,

□□ □□: 54.3 \* 13.5 \* 19.3cm, □ □□: 25kg □□□□ 50□ □□





### ACM-Y280N

□□□□ □□ □□□□(280kgs / 600lbs) □□□ □□:  
□□ □, □□ □, □□ □, □□ | □□□

### ACM-Y180

□□ □□□(180kg / 300lbs) □□ □□ □□ 2□□ □□  
□□□.

### ACM-Y280

280kg(600lbs) □ □□□ □ □□ □ □□□: □□□ □□

□, □□□ □, □□ □, □□□ □.



### ACM-Y350

□ □□ □□□ □ □□ □ □□ □□□ 350kgs (800lbs):  
□□□ □□ □, □□□ □, □□ □, □□□ □.

### ACM-Y500

□ □□ □□□ □ □□ □ □□ □□□ 500kgs  
(1000lbs): □□□ □□ □, □□□ □, □□ □, □□□ □.

### ACM-Y280-W

□ □□ □ □□ □□□ 280kgs (600lbs) □□. □ □□  
□□□: □□□ □□ □, □□□ □, □□ □, □□□ □.

## You may need



### ACM-Y100S

□□ □□ □□(5PIN) □□ □□ □□ □□ □□ □□  
□□

### ACM-Y130

□□□ □□□□(NC / NO□□)  
□□ □□: 110x28x31mm

### ACM-Y066

□□□ □□□ □□(□□ □□)  
□□□

## 我們 服務

- 1, 我們 提供 24小時 服務 團隊。
- 2, 我們 提供 一 系列, 我們 提供 一 系列 服務 團隊
- 3, 我們 OEM/ODM
- 4, 我們, fashin desing, 我們 & 我們, 我們 服務
- 5, 我們 一 系列:
- 1), 我們 提供 我們 一 系列 服務 團隊 服務 團隊。
- 2) 我們 提供 我們 一 系列 服務。
- 3) 我們 提供 我們 一 系列 服務 團隊 2-30 我們 服務。
- 6, 我們 一 系列 : 我們 一 系列 1~50, 我們 一 系列 7~300 我們 服務。
- 7, 我們: T / T, Western Union, Paypal 我們 一 系列 服務 一 系列。
- 8, 我們: 我們 DHL, FEDEX, TNT, UPS, EMS, SEA 我們 一 系列 服務 一 系列 AIR 我們 一 系列 服務 一 系列 服務。

# 20<sup>+</sup> YEARS EXPERIENCE OEM & ODM

## ACCESS CONTROL SYSTEMS ONE STOP SOLUTION PROVIDER

Goldbridge is Top 10 China Manufacture On Alibaba, Specializes In Provide Kinds Of RFID/NFC Cards, FID Tags, RFID Card Reader, UHF Reader, Access Control System, Electromagnetic Locks, etc Since 1999



Customized Services



Quality Assurance



Fast Delivery



Best After-Sales Service

## OUR FACTORY



### Access Control and RFID Reader Production Line:

- Monthly production quantity is up to 50,000pcs, We are Provides OEM&ODM services including product research and development, LOGO printing, customized etc



### Door Lock Production Line

### Electromagnetic lock & Smart Door Lock Production Line :

- Monthly production quantity is up to 100,000pcs,
- Our factory is built with modern manufacture environment, facilities, equipment and professional operation technicians.
- Goldbridge Provides OEM&ODM services including product research and development, LOGO printing and product box customized.



### RFID Cards & Tags Production Line

### RFID & NFC Cards & Tags Production Line :

- RFID Tag, Wristband, Keyfob: 11,000,000pcs (monthly output)
- Four Production Lines For Smart Card, PVC Card, Prelam Sheet: 20,000,000pcs (monthly output)
- Goldbridge Provides OEM&ODM services for LOGO printing, development, customized.

## ADVANTAGE



### WHY CHOOSE US?

- 1 FAST DELIVERY** Faster delivery by air by express. (DHL, UPS or Fedex)
- 2 LONG HISTORY** 20 years experience in RFID & Access Control industry
- 3 OEM ACCEPTABLE** 20 years OEM&ODM experience for 1000 + VIP client from US and Europe
- 4 HIGH QUALITY** Design and manufacture high quality products with 30 R&D; engineers.

## APPLICATION

Bus, supermarket, school, government, hospital, factory



## CERTIFICATE



