

180KG Single Door EM Lock with 5wires

Model No.: ACM-Y180

What is Electromagnetic Lock?

Electromagnetic locks consist of an armature and a coil assembly, which become magnetized when an electric current passes through them. This magnetic field secures the door and electronically controls when doors are locked and unlocked.

Electromagnetic locks are fail-safe by design.

Lock Size	200Lx41.7Wx21.7H(mm)
Armature plate	130Lx33Wx10.5H(mm)
Holding Force	180KG(350Lbs)
Voltage	DC12V or DC24V (24V need to customize)
Current Draw	12V/280mA 24V/150mA
Signal Output	Pls see EL-350TS
Suitable for	Wooden door, Glassdoor, Metal door, Fireproof door
Surface Temp	≤20°C
Operating Temp	-10°C ~ 55°C (14°F~131°F)
Suitable Humidity	0~90%(non-condensing)
Finishes for Shell	Anodized aluminum surface texture processing
Finishes for Magnetic	Zinc
Finishes for Armature	Zinc
Weight	1.2kg
Standard Packing	20pcs

Installation fitting for electromagnetic lock support

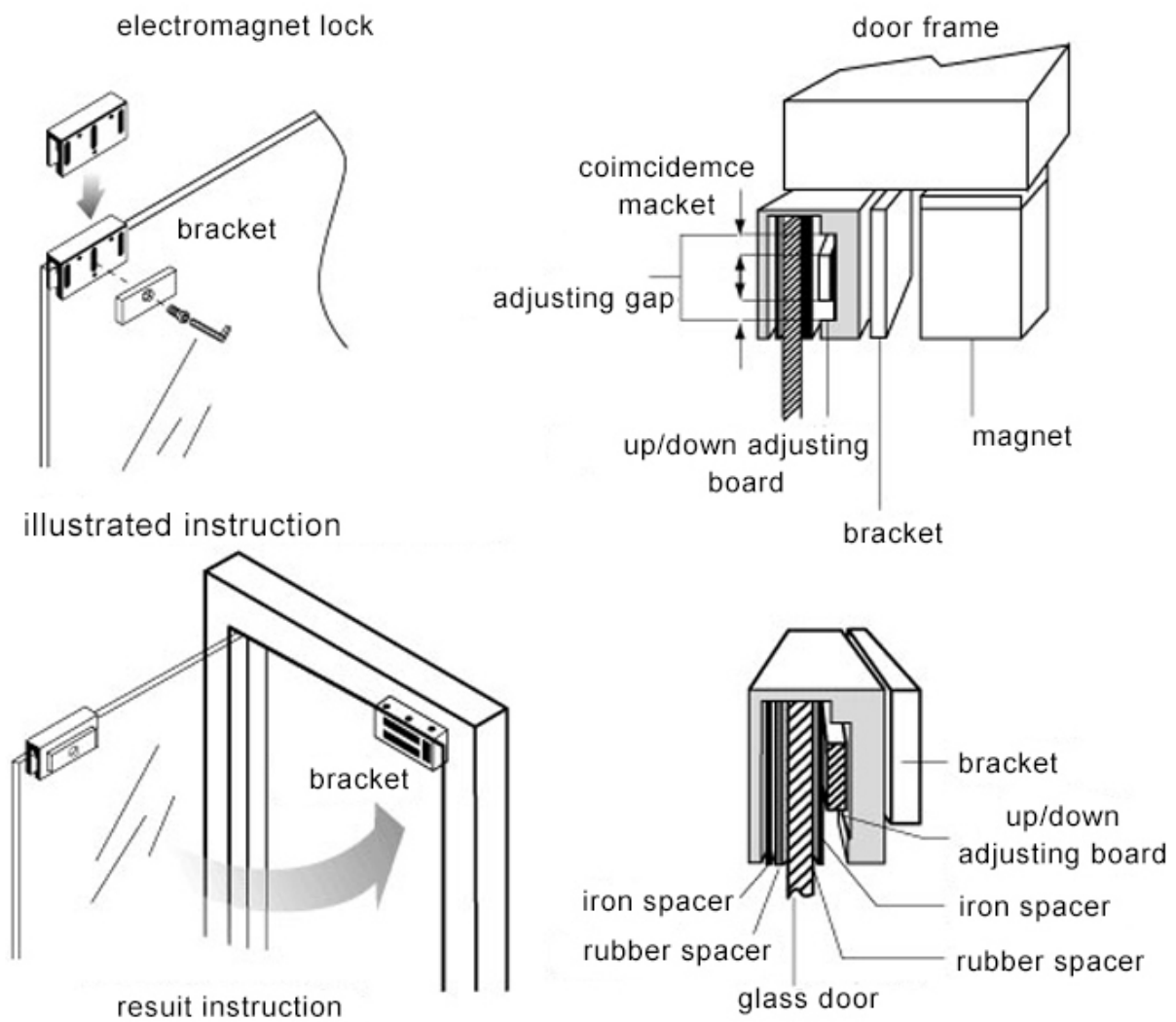

Instalation Diagram

STANDARD INSTALLATION STEPS

Professional guidance, Rest assured

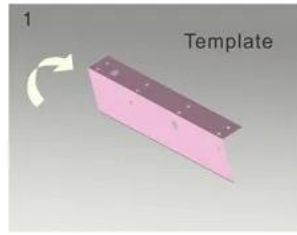

1 Fold the plate to 90° .

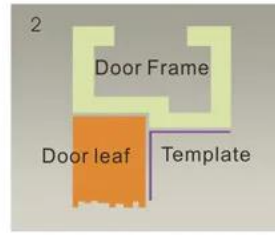

2 Close the door first, then place the upper side of template on door frame, while adjust the left side next to the door leaf.

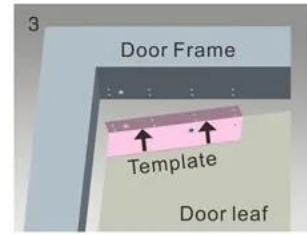

3 Mark screw positions of armature plate and magnetic lock on door leaf and door frame respectively.



4 Drill holes based on the marked positions.

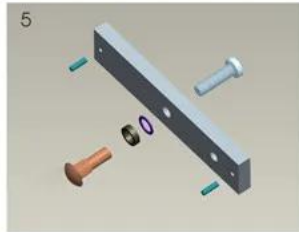

5 Make a combination based on the picture.

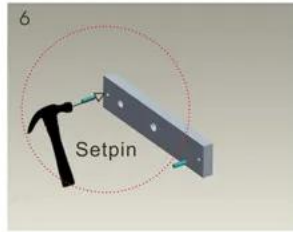

6 Strike the pin into the armature plate slightly (to avoid movement).

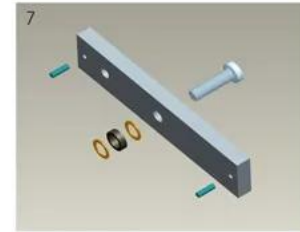

7 Make a combination based on the picture (add washer accordingly). The rubber ring must be added.

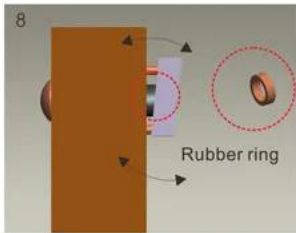

8 Place the rubber ring between armature plate and door leaf.



9 Use Allen key to remove the mounting plate from lock body.

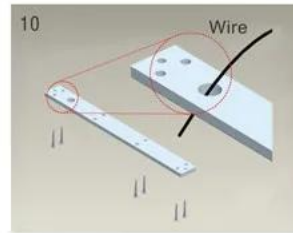

10 Fix the mounting plate on the door frame according to the holes drilled earlier.

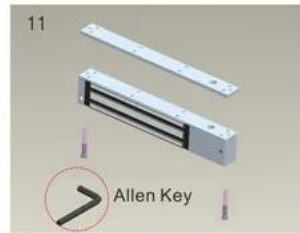

11 Use Allen key to screw the lock body on the mounting plate.

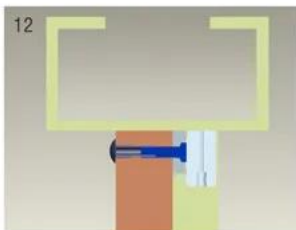

12 Close the door to test holding force. The angle between armature plate and magnetic lock can be adjusted by adding or reducing washers.

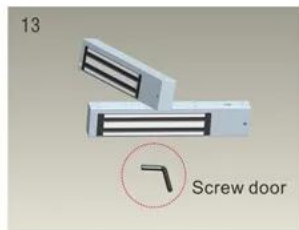

13 After all the appropriate procedures, the holding force can be maximized. Finally, fix the tamper screw.

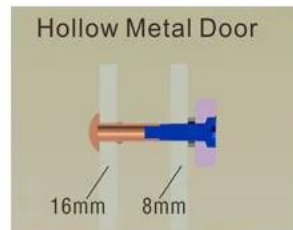

Hollow Metal Door
Drill a hole
Inside: Diameter is 8mm
Outside: Diameter is 16mm

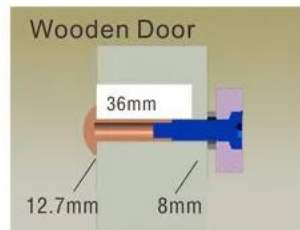

Wooden Door
Drill a hole
Inside: Diameter is 8mm
Outside: Diameter is 12.7mm

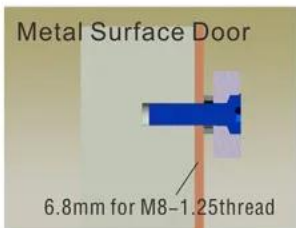

Metal Surface Door
Inside: Drill a hole
diameter is 8mm folding
the plastic straight pin

Notice:

Thickness of Door Leaf:

350LBS: 44mm

600LBS: 50mm

800LBS: 48mm

1200LBS: 46mm

Packing & Delivery

Shipping Way

We have strong cooperation with DHL, FEDEX, TNT, UPS, EMS, Forwarder by SEA and By AIR
You also can choose your own shipping forwarder.

Packaging

Magnetic Lock packaging: 1unit per box, 10pcs per carton,
Carton size : 26*26*10cm , Gross Weight :46kg. 50 cartons per pallet



Related Products



ACM-Y280N

Backplate magnetic lock
(280kgs/600lbs) Suitable For:
Wooden Door, Glass Door, Metal
Door, Fire| Proof Door

ACM-Y180

Surface mounted (180kg/300lbs)
magnetic lock 2Bolts Fail
safe.Suitable For: Wooden Door,

Glass Door, Metal Door, Fire Proof Door.

ACM-Y280

280kg(600lbs) Single Door magnetic Lock Suitable For: Wooden Door, Glass Door, Metal Door, Fire Proof Door.



ACM-Y350

Single Door Magnetic Lock
350kgs(800lbs) Suitable For:
Wooden Door, Glass Door, Metal
Door, Fire Proof Door.

ACM-Y500

Single Door Magnetic Lock
500kgs(1000lbs) Suitable For:
Wooden Door, Glass Door, Metal
Door, Fire Proof Door.

ACM-Y280-W

Single Door Magnetic Lock
280kgs(600lbs) Waterproof.Suitable
For: Wooden Door, Glass Door, Metal
Door, Fire Proof Door.

You may need





ACM-Y100S

Electric Bolt Lock (5PIN) Fail safe
electric bolt with magnetic feature

ACM-Y130

Electric strike Lock (NC/NOOptional)
Lock Size : 110x28x31mm

ACM-Y066

Intelligent Smart Lock (motor lock)
Lock size: 130x98x41mmWorking

Bracket Need with Door Magnetic Lock





ACM-Y180-L

L Bracket for 180kg Magnetic Lock

ACM-Y180ZL

ZL Bracket for 180kg/300lbs
Magnetic Lock

ACM-Y180-ZL

ZL Bracket for 180Kg Magnetic Lock

Our Service

- 1, Any inquires will be replied within 24 hours
- 2, Professional manufacturer and supplier, Welcome to visit our website and our factory
- 3, OEM/ODM Available
- 4, High quality, fashin desing, reasonable & competitive price, fast lead time
- 5, After-sale Service :
 - 1), All products will have been strictly quality checked in house before packing
 - 2), All products will be well packed before shipping
 - 3), All our products have 2-3 year warranty if the damage is not caused by human
- 6, Faster delivery : Around 1~ 5 days for sample order, 7~30 days for bulk order
- 7, Payment : You can pay for the order via : T/T, Western Union, Paypal
- 8, Shipping: We have strong cooperation with DHL, FEDEX, TNT, UPS, EMS, Forwarder by SEA and By AIR, You also can choose your own shipping forwarder.