



Product Description



Packing & Delivery



Shipping Way

We have strong cooperation with DHL, FEDEX, TNT, UPS, EMS, Forwarder by SEA and By AIR You also can choose your own shipping forwarder.

Packaging

Magnetic Lock packaging: 1unit per box, 10pcs per carton,

Carton size : 26*26*10cm , Gross Weight :46kg. 50 cartons per pallet

Quality assurance

- Warranty service will be honored if the damage is not caused by human, ACM Goldbridge provides 2 years warranty for related products.
- On the contrary, ACM Goldbridge requires extra in case of repair.
- Consult our service center for more information.

Installation diagram

STANDARD INSTALLATION STEPS

Professional guidance, Rest assured

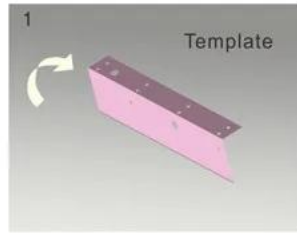

1 Fold the plate to 90° .

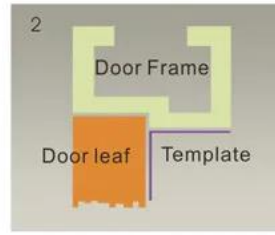

2 Close the door first, then place the upper side of template on door frame, while adjust the left side next to the door leaf.

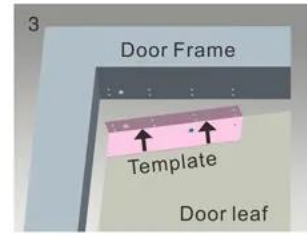

3 Mark screw positions of armature plate and magnetic lock on door leaf and door frame respectively.



4 Drill holes based on the marked positions.

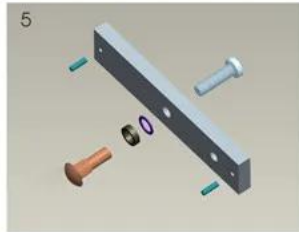

5 Make a combination based on the picture.

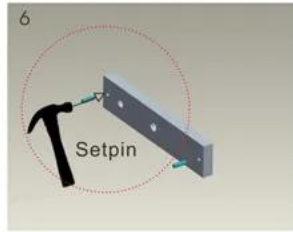

6 Strike the pin into the armature plate slightly (to avoid movement).

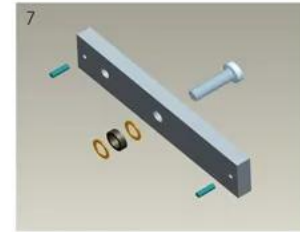

7 Make a combination based on the picture (add washer accordingly). The rubber ring must be added.

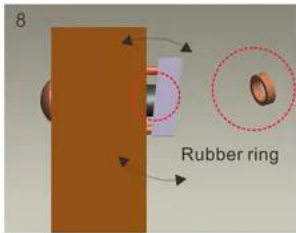

8 Place the rubber ring between armature plate and door leaf.



9 Use Allen key to remove the mounting plate from lock body.

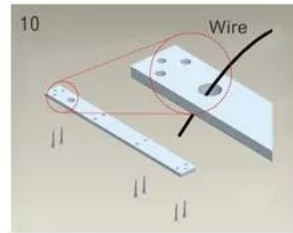

10 Fix the mounting plate on the door frame according to the holes drilled earlier.

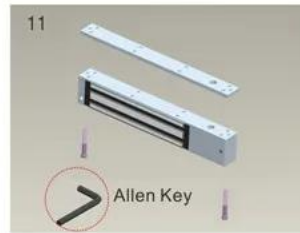

11 Use Allen key to screw the lock body on the mounting plate.

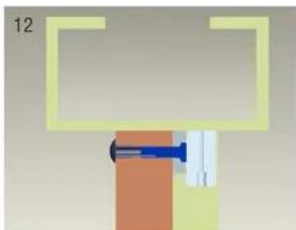

12 Close the door to test holding force. The angle between armature plate and magnetic lock can be adjusted by adding or reducing washers.

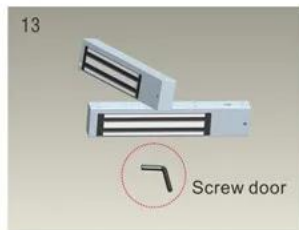

13 After all the appropriate procedures, the holding force can be maximized. Finally, fix the tamper screw.

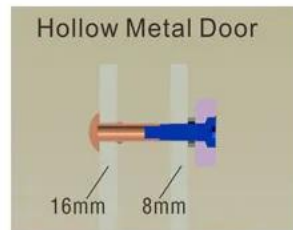

Hollow Metal Door
Drill a hole
Inside: Diameter is 8mm
Outside: Diameter is 16mm

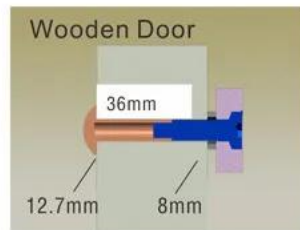

Wooden Door
Drill a hole
Inside: Diameter is 8mm
Outside: Diameter is 12.7mm

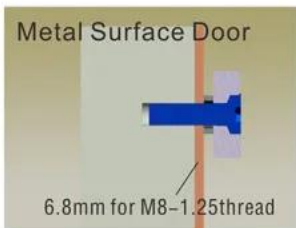

Metal Surface Door
Inside: Drill a hole
diameter is 8mm folding
the plastic straight pin

Notice:

Thickness of Door Leaf:

350LBS: 44mm

600LBS: 50mm

800LBS: 48mm

1200LBS: 46mm

Packaging and delivery

shipping way

We have strong cooperation with DHL, FEDEX, TNT, UPS, EMS, SEA and AIR with Forwarder.
You can also choose your own forwarder.

Packaging

Magnetic lock packaging: 1 unit per box, 6 pcs per carton,
Carton size: 35*30*20cm, gross weight: 24kg. 50 cartons per pallet



You may need



ACM-Y280N

Magnetic lock with back plate (280 kg / 600 lbs) Suitable for: wooden door, glass door, metal door, fire door | test port

ACM-Y180

Magnetic Surface Mount Lock (180kg / 300lbs) Fail Proof with 2 Latches.

ACM-Y280

280kg (600lb) single door magnetic lock is suitable for: wooden door, glass door, metal door, fire door.



ACM-Y280-L

L bracket for 280 kg / 350 kg magnetic lock

ACM-Y180ZL

ZL bracket for 180kg / 300lbs magnetic lock

ACM-Y280-ZL

ZL bracket for 280Kg / 350Kg

magnetic lock

Our service

- 1, All questions will be replied within 24 hours.
- 2, professional manufacturer and supplier, welcome to visit our website and factory
- 3, OEM/ODM are available
- 4, high quality, fashion design, reasonable and competitive price, fast delivery time
- 5, after-sales service:
 - 1), All products will be strictly checked in house before packing.
 - 2), all products will be well packed before shipping
 - 3), All of our products are guaranteed for 2-3 years if the damage is not caused by man.
- 6, faster delivery : About 1~5 days for sample order, 7~30 days for bulk order
- 7, payment: You can pay for the order: T/T, Western Union, Paypal.
- 8, Shipping: We have strong cooperation with DHL, FEDEX, TNT, UPS, EMS, SEA and AIR with Forwarder, you can also choose your own forwarder.

FAQ

Q: 1. How can I place an order?

A: Please specify your requirements by e-mail. Then we will send your quotation to you as soon as possible, after your order is confirmed, we will arrange the production as soon as possible.

Q: 2. What about payment and shipping?

A: Trade assurance and T/T, Paypal, Western Union.

Customers can ship by sea, by air or by express (DHL, FedEx, TNT UPS etc.)

Q: 3. How can I get a sample to check the quality?

A: We can provide you with free samples and freight paid by you.

Q: 4. How long can I get the samples?

A: It depends on the quantity. Normally 3-7 days for 5000 pieces and 7-15 days for 100,000 pieces

Q: 5. Can your products be customized?

A: Almost all of your products are customized, including material, size, thickness and printing. OEM orders are accepted.

Q: 6. Are you a trading company or factory?

We are one of the largest manufacturers of RFID card / NFC tags / RFID keybods / RFID bracelet, RFID reader and access control products in China for over 20 years.