

Product description



RFID infrared sensor without door access control exit button

1. Aluminum panel with elegant style
2. Tested on 500,000 cycles
3. Three contact exits, suitable for all types of locks
4. The best choice for access control

access control exit button Technical specifications:

-
9
5
S
ü
r
e
h
b
t
e
h
a
m
u
n
i
d
y
t
y
)
D
e
t
e
c
t
i
o
n
f
i
e
l
d

exit button access control Advantage:

- . No touch / Contactless exit sensor (diffuse detection)
 - Optical / infrared technology
 - IP-55 plate for ingress protection / SUS 304 stainless steel
 - Easy to use (healthy protection)
- Free from the spread of contagious diseases
- Detection range: 0.1 ~ 10 cm
 - Application: gate / door / exit / automation control
 - High dry contact capacity of the relay (3A / AC120V, DC30V)
 - Normally open / normally closed / common exit
 - Twin LED indicators for sensor waiting or approach:
- (1) Sensor standby: BLUE LED ON
(2) Visitors who approached the sensor in 10 cm: RED LED ON

[Detailed images](#)

**Blue LED Indicator:
Power ON (Standby)**



**Red LED Indicator:
Power ON (Triggered)**

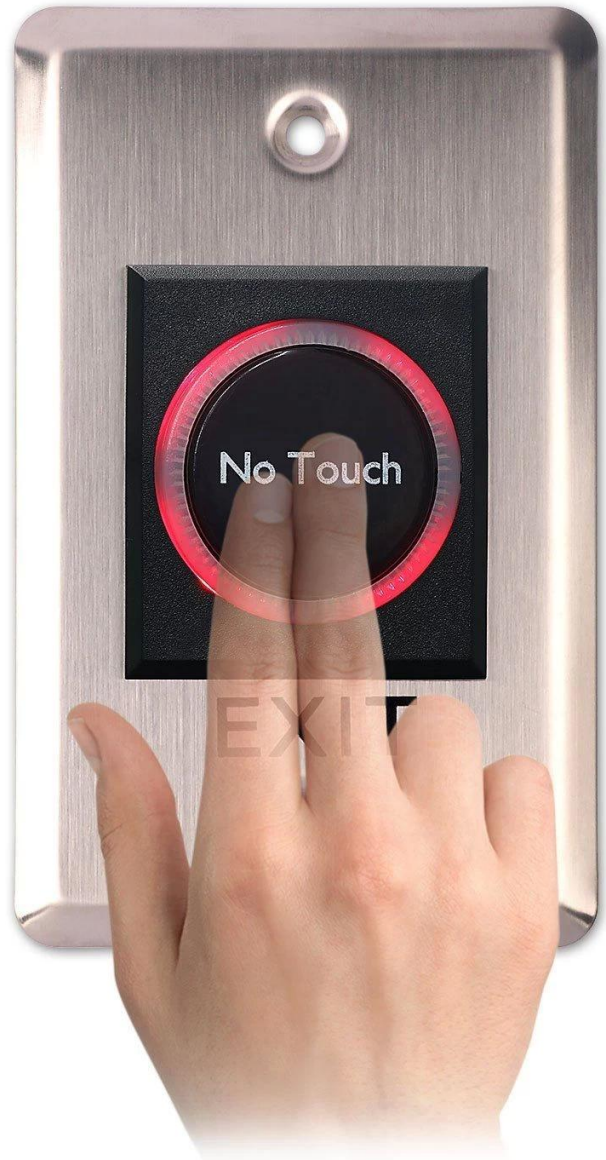

+12V	GND	NO	COM	NC
Red	Black	Yellow	White	Orange

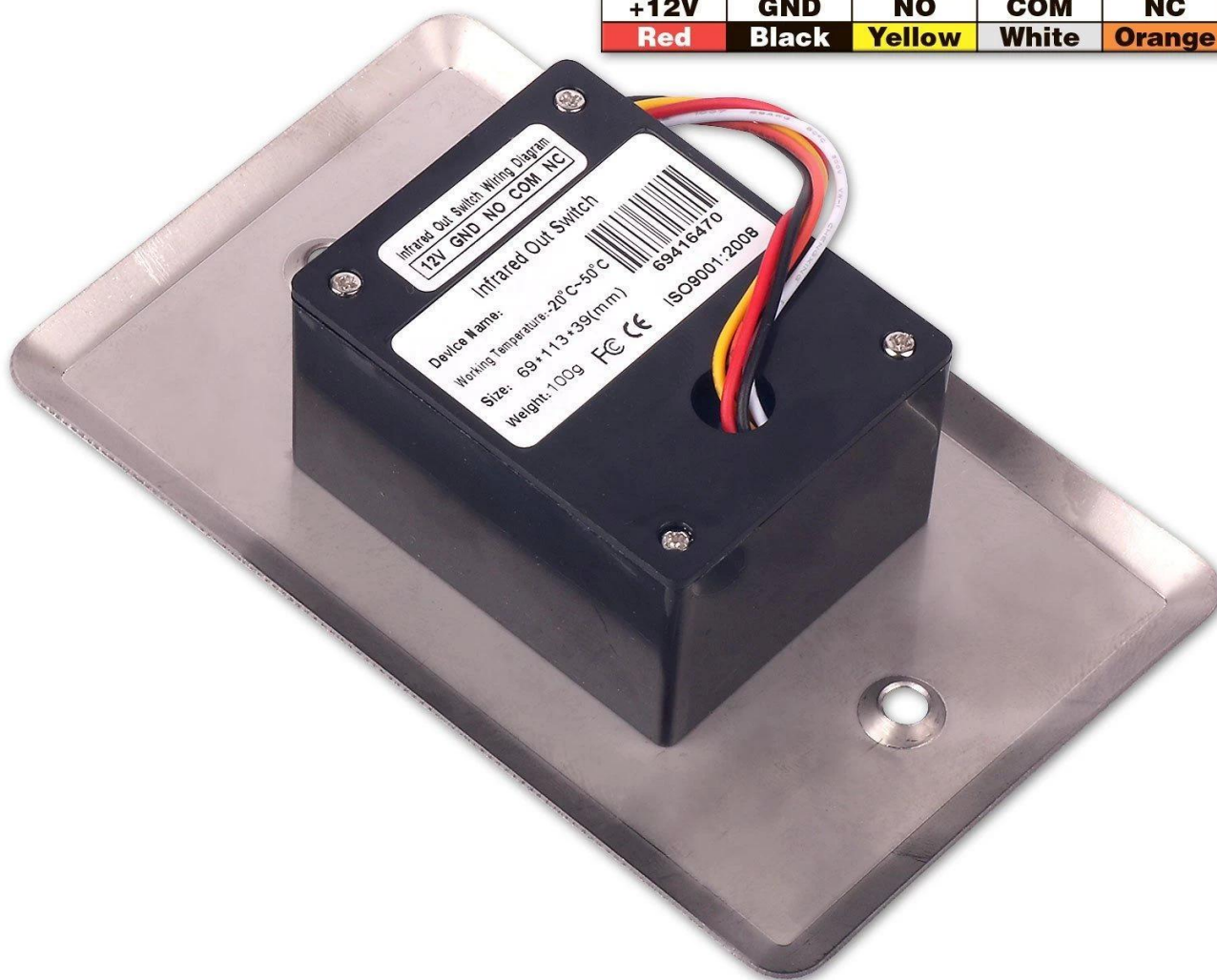

[Click here to order and get your FREE SAMPLE in 3 days !!!](#)

We are a complete supplier of professional security access control products with 20 years of experience, we make sure we offer the best access control solution! So, send the details of your request below, click "Send" now!

We look forward to establishing successful business relationships with new customers around the world in the future.

Application

Installation



Sensing Range



LED Indicator



A: Black / PC Lens
B: Round Shape LED Indicator

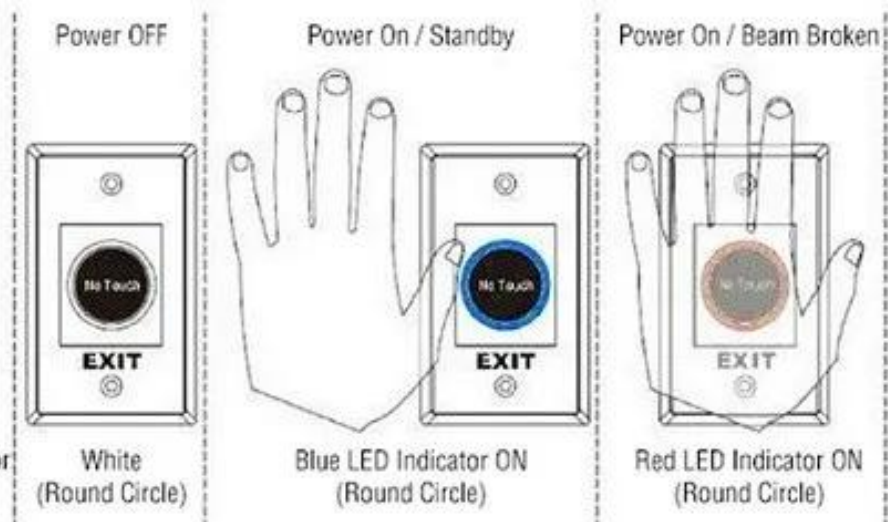

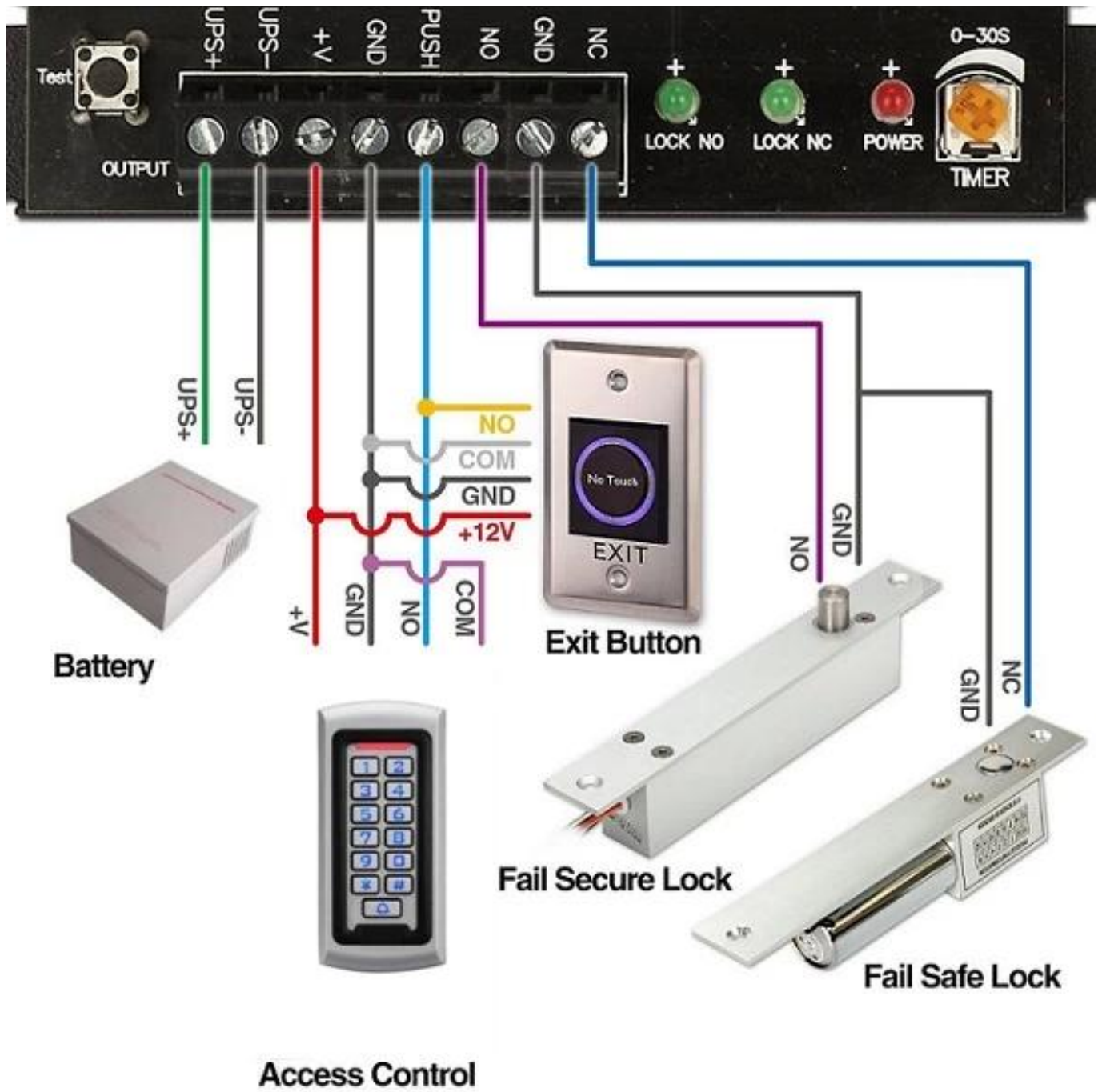

Packaging & Delivery

Type of unit: piece

Package weight: 0.3 kg

Packaging: 10cm x 10cm x 8cm





Shipping method

We are one of the leading exporters of RFID products in China for 2000 years. With a rich international business experience, we know international shipping very well. We know which express or air / sea line is cheap and safe for your country. We can provide various certificates for you to clean your habits like CO, FTA, Form F, Form E ... Ect. We will provide our professional shipping suggestion. EXW, FOB, FCT, CIF, CFR ... commercial term are ok for us. We can be your reliable partner for products and shipments.

Your may need

We can supply many types of door switches. Touch, No touch, glass break, key switch. Click on photo to find more details. Or feel free to send us a request to ask for the price list.





Exit button on the Real Touch port
K2B: 86 * 86mm

Real Touch door exit sensor without
contact
K9A: 115 * 40mm

Door release button, (stainless steel,
NO / NC) K5B: 86 * 86 mm



Door release button, (aluminum steel, NO), K4B: 86 * 86 mm

High quality stainless steel Kirsite. K14B: 86 * 86 mm

PUSH door release button in stainless steel; K815B: 86 * 86 mm

Our service

- 1st Any request will be answered within 24 hours
- 2, professional manufacturer and supplier, welcome to visit our website and our factory
- 3, OEM / ODM available
- 4, high quality, fashion design, reasonable & competitive price, fast lead time
- 5, after-sales service:
 - 1), all the products will have been strictly checked at home before being packed
 - 2), all products will be well packed before shipment
 - 3), all our products have 2-3 years warranty if the damage is not caused by human
- 6, faster delivery : About 1 ~ 5 days for sample order, 7 ~ 30 days for bulk order
- 7, payment: You can pay for the order via: T / T, Western Union, Paypal
- 8, shipping: We have a strong collaboration with DHL, FEDEX, TNT, UPS, EMS, SEA Forwarders and By AIR, you can also choose your shipping forwarder.

FAQ

Q: 1. How can I place an order?

A: Please list your needs to us by e-mail. Then we will send the offer to you as soon as possible, after order confirmation, we will organize the production as soon as possible.

Q: 2. What about payment and shipment?

A: T / T, Paypal, Western Union.

Customers can choose by sea, air or express (DHL, FedEx, TNT UPS etc.)

Q: 3. How can I get a sample to check the quality?

A: We could supply the free sample to you and the freight cost paid by you.

Q: 4. How long can I expect to get the samples?

A: it depends on the quantity. Normally 3-7 days for 5000 pieces and 7-15 days for 100,000 pieces

Q: 5. Can your products be customized?

A: Almost all your products are customized, including the material, size, thickness and printing. OEM orders are highly welcome.

Q: 6. Are you a trading company or factory?

We are one of the largest manufacturers of RFID cards / NFC tags / RFID keybods / RFID bracelets, RFID readers and access control products in China for over 20 years.