



## Holding force 280kg Electric lock magnetic lock with LED, signal output or delayed frameless glass door magnetic lock

Hidden magnetic lock with 600 lbs (280 kg) holding force for single door

P  
a  
P  
a  
m  
e  
t  
e  
t  
p  
e  
s  
a  
m  
e  
p  
e  
r  
o  
n

2 2 4 B l l x o 4 c 6 W k k s 3 n 3 n H e . m m ) 1 9 l k k l l B o p l x x H 4 4 u u c W o k l l a l l H e . m m ) H 2 2 s s k k p p c c p p o o l l a a n n s s . .

D  
u  
a  
I  
n  
p  
h  
t  
a  
g  
e  
1  
a  
g  
e  
4  
V  
D  
C

Wooded  
door,  
Gulches  
border  
the  
Meadow  
border  
door,  
Fire  
door

B  
l  
o  
c  
k  
s  
i  
n  
g  
r  
e  
s  
s  
a  
p  
p  
r  
o  
p  
r  
i  
e  
t  
y  
N  
O  
T  
F  
O  
R  
C  
/C  
O  
M  
/  
+  
/  
-

F  
a  
i  
l  
S  
a  
f  
e  
,  
t  
i  
m  
e  
d  
d  
e  
l  
a  
y  
,  
C  
h  
a  
n  
h  
a  
t  
k  
s  
i  
g  
n  
i  
c  
;  
d  
u  
a  
l  
v  
o  
l  
t  
a  
g  
e  
1  
2  
V  
/  
2  
4  
V  
D  
C

R  
e  
d  
s  
h  
o  
w  
s  
u  
n  
l  
o  
c  
k  
E  
U  
D  
D  
E  
e  
e  
n  
s  
h  
o  
w  
s  
l  
o  
c  
k  
e  
d  
W  
a  
i  
t  
i  
n  
g  
:  
C  
e  
r  
t  
i  
f  
i  
c  
a  
t  
e  
:  
M  
a  
t  
i  
o  
n  
:

## Advanatge product

- Collinear load test 280kg, 600lbs.
- Dual voltage 12 or 24 VDC (optional).
- Standard voltage is 12VDC when finished.
- MOV provides reverse current protection.
- Suitable for wooden doors, glass doors, metal doors, fire doors.
- LED Indicates the status of the door.
- Block status sensor (NO / NC / COM)
- Door status sensor (NO / NC / COM)
- Anti-residue magnetism designed.
- High strength material, anodized aluminum housing.
- Design without mechanical failures.
- Increase the holding force, double insulated housing.
- CE certified by the European Union, MA certified by the Chinese Public Security Bureau

Detailed pictures, OEM / ODM available





Our lock is with LED light to show the working statue, the light is green when locked, red when unlocked . The glowing statue can be changed.

ACM-Y280 is equipped with signal output. The PCB board can be customized. We can make the lock with dual voltage 12v and 24v and with 7-wire connection. The following photo is the optional PCB board.If you want to customize the lock, please tell us your detail request, we will send your detailed quotation after knowing all your needs.

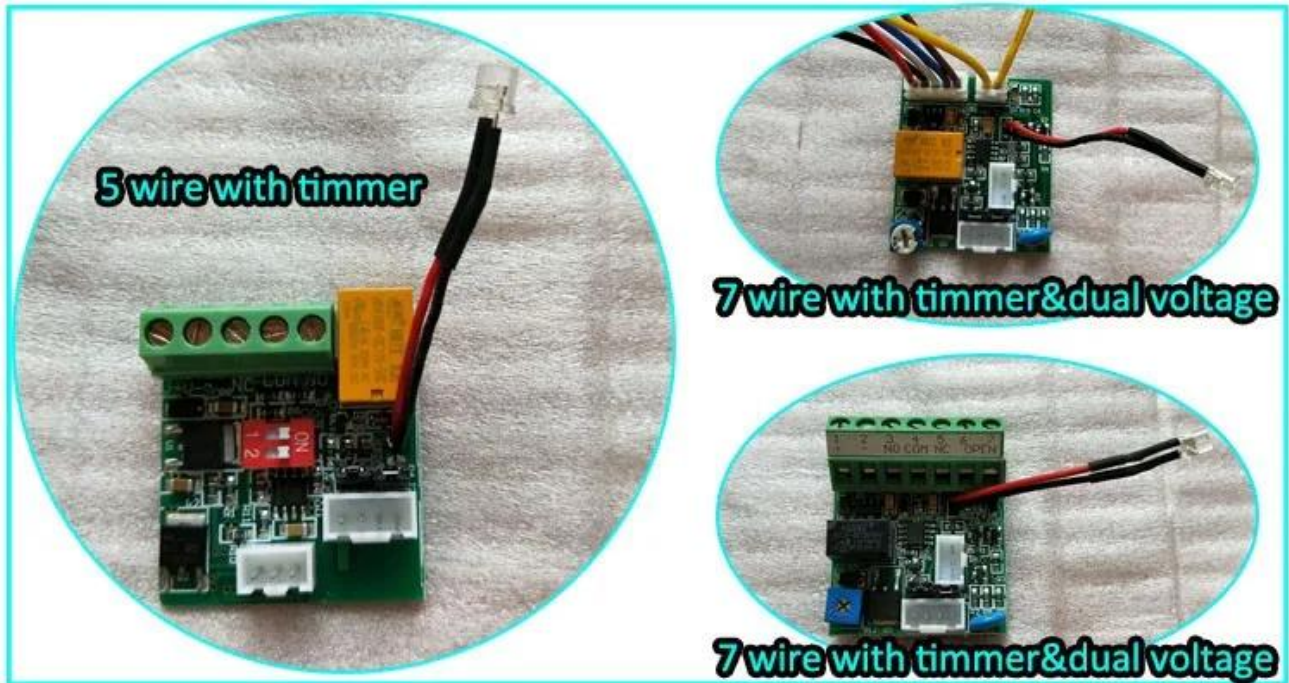

## Quality assurance

- Warranty service will be honored if the damage is not caused by people, ACM Goldbridge provides 2 years warranty for related products.
- On the contrary, ACM Goldbridge will require extra in case of repair.
- More information, please consult our service center.

## Installation diagram

# STANDARD INSTALLATION STEPS

Professional guidance, Rest assured

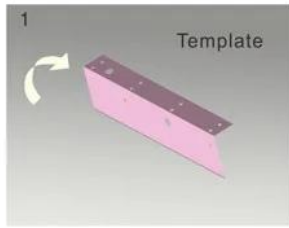

1 Fold the plate to 90° .

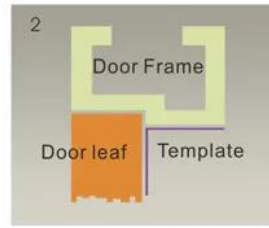

2 Close the door first, then place the upper side of template on door frame, while adjust the left side next to the door leaf.

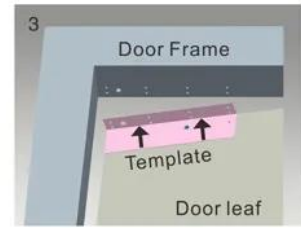

3 Mark screw positions of armature plate and magnetic lock on door leaf and door frame respectively.



4 Drill holes based on the marked positions.

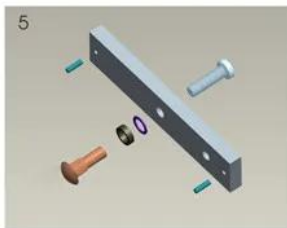

5 Make a combination based on the picture.

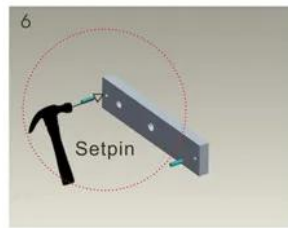

6 Strike the pin into the armature plate slightly (to avoid movement).

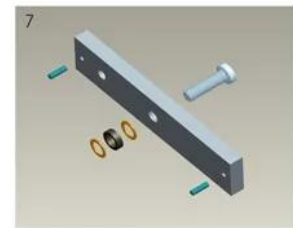

7 Make a combination based on the picture (add washer accordingly). The rubber ring must be added.

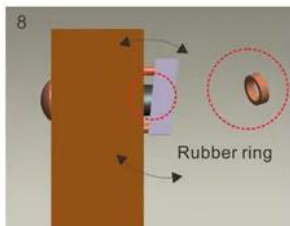

8 Place the rubber ring between armature plate and door leaf.



9 Use Allen key to remove the mounting plate from lock body.

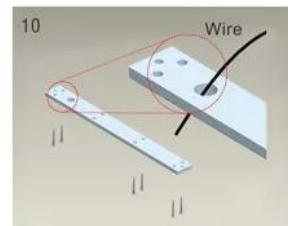

10 Fix the mounting plate on the door frame according to the holes drilled earlier.

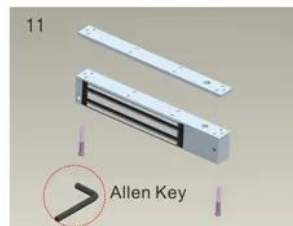

11 Use Allen key to screw the lock body on the mounting plate.

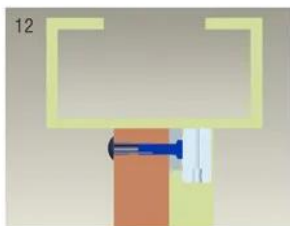

12 Close the door to test holding force. The angle between armature plate and magnetic lock can be adjusted by adding or reducing washers.

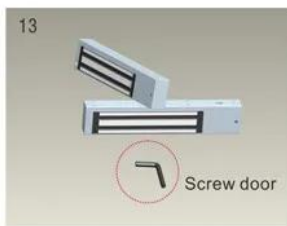

13 After all the appropriate procedures, the holding force can be maximized. Finally, fix the tamper screw.

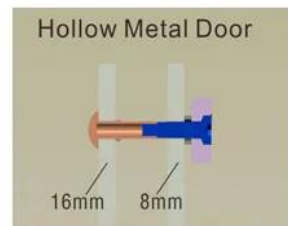

Hollow Metal Door

Drill a hole  
Inside: Diameter is 8mm  
Outside: Diameter is 16mm

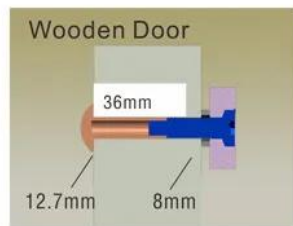

Wooden Door

Drill a hole  
Inside: Diameter is 8mm  
Outside: Diameter is 12.7mm

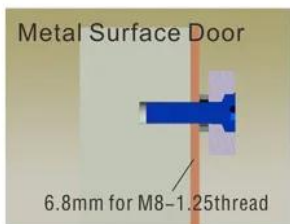

Metal Surface Door  
Inside: Drill a hole diameter is 8mm folding the plastic straight pin

## Notice:

Thickness of Door Leaf:

350LBS: 44mm

600LBS: 50mm

800LBS: 48mm

1200LBS: 46mm

## Packaging and delivery

### Shipping way

We have strong cooperation with DHL, FEDEX, TNT, UPS, EMS, Forwarder by SEA and By AIR  
You can also choose your own forwarder.

### Packaging

Magnetic lock packaging: 1 unit per box, 10 pcs per carton,  
Carton size: 26 \* 26 \* 10cm, gross weight: 46kg. 50 cartons per pallet





We are professional suppliers of full security access control products with 20 years of experience, we make sure to offer the best access control system solution! So, submit your inquiry details below, click "Submit" now! We are looking forward to establishing successful business relationships with new customers around the world in the future.

## Our service

- 1, All inquiries will be answered within 24 hours
- 2, professional manufacturer and supplier, welcome to visit our website and factory
- 3, OEM / ODM available
- 4, high quality, fashion design, reasonable and competitive price, fast delivery time
- 5, after-sales service:
  - 1), All products will have been strictly checked in house before packing
  - 2), All products will be well packed before shipping
  - 3), All of our products have 2-3 years warranty if the damage is not caused by man
- 6, faster delivery : About 1 ~ 5 days for sample order, 7 ~ 30 days for bulk order
- 7, payment: You can pay for the order by: T / T, Western Union, Paypal, Ali trade assurance
- 8, Shipping: We have strong cooperation with DHL, FEDEX, TNT, UPS, EMS, Forwarder by SEA and By AIR, you can also choose your own forwarder.

### OUR COMPANY :

#### **Industrial company ACM Shenzhen Goldbridge**

As one of the leading manufacturers and exporters of RFID, access control and electric lock products in China, we have been operating in this field for 20 years already. We have rich experience in manufacturing and exporting RFID access control lock products. Our strength products are: RFID card, RFID key fob, RFID bracelet, RFID tag and various RFID readers, long range UHF reader, electric locks,. We are also the provider of access control solutions.

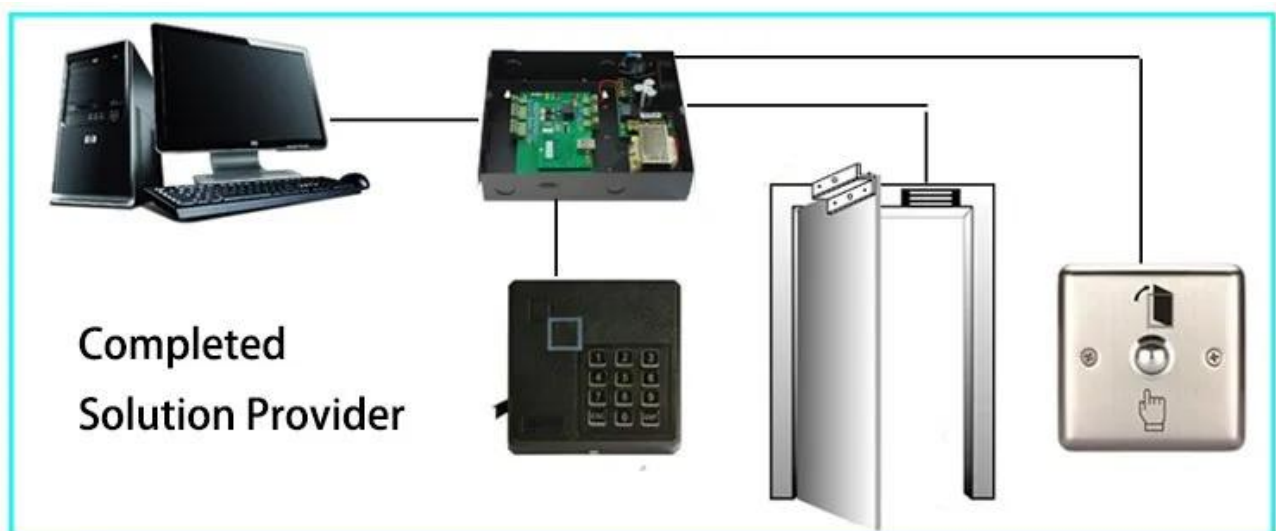

## Contact us

Send us a request and order now to get your FREE SAMPLE in 3 days !!!

We are professional and make sure we can offer the best solution from a full supplier of RFID security card access control products with 20 years of experience,

So, contact us and submit your inquiry details below now!

We are looking forward to forging successful business relationships with new customers around the world in the future!



**SHENZHEN GOLDBRIDGE INDUSTRIAL CO., LTD**

**Address:** Futian District, Shenzhen of China

**Telephone:** +86-755-83767678

**Contact Person:** Lily Jiang

**WhatsApp and Mobile Phone:** +86-13554918707

**Skype:** lily-jiang1206

**E-mail:** sales@goldbridgesz.com

**Website:** <http://www.goldbridgesz.com>