

**100LBs 60kg Small Electromagnetic Lock, 12V Electric Magnetic Door Locks for Access Control  
Single Door, 12V Electric Magnetic Electromagnetic Lock**

**Model No.: ACM-Y60**

**What is Electromagnetic Lock?**

Electromagnetic locks consist of an armature and a coil assembly, which become magnetized when an electric current passes through them. This magnetic field secures the door and electronically controls when doors are locked and unlocked.

Electromagnetic locks are fail-safe by design.

Item	Parameter
Lock size	79Lx40Wx23H(mm)
Armature plate	75Lx31Wx10H(mm)
Holding force	60kg(100Lbs)
Voltage	DC 12V
Current draw	12V/160mA
Suitable for	File Cabinet, Display Cabinet
Operating temp	≤20°C
Surface temp	-10°C ~ 55°C (14°F~131°F)
Suitable humidity	0~90% (non-condensing)
Finishes for shell	Anodized aluminum surface texture processing
Finishes for magnetic	Zinc
Finishes for armature	Zinc
Weight	0.6kg
Standard packing	60pcs

complete package include



## Installation

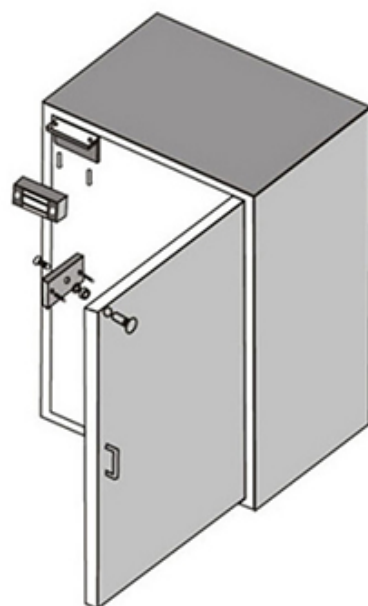

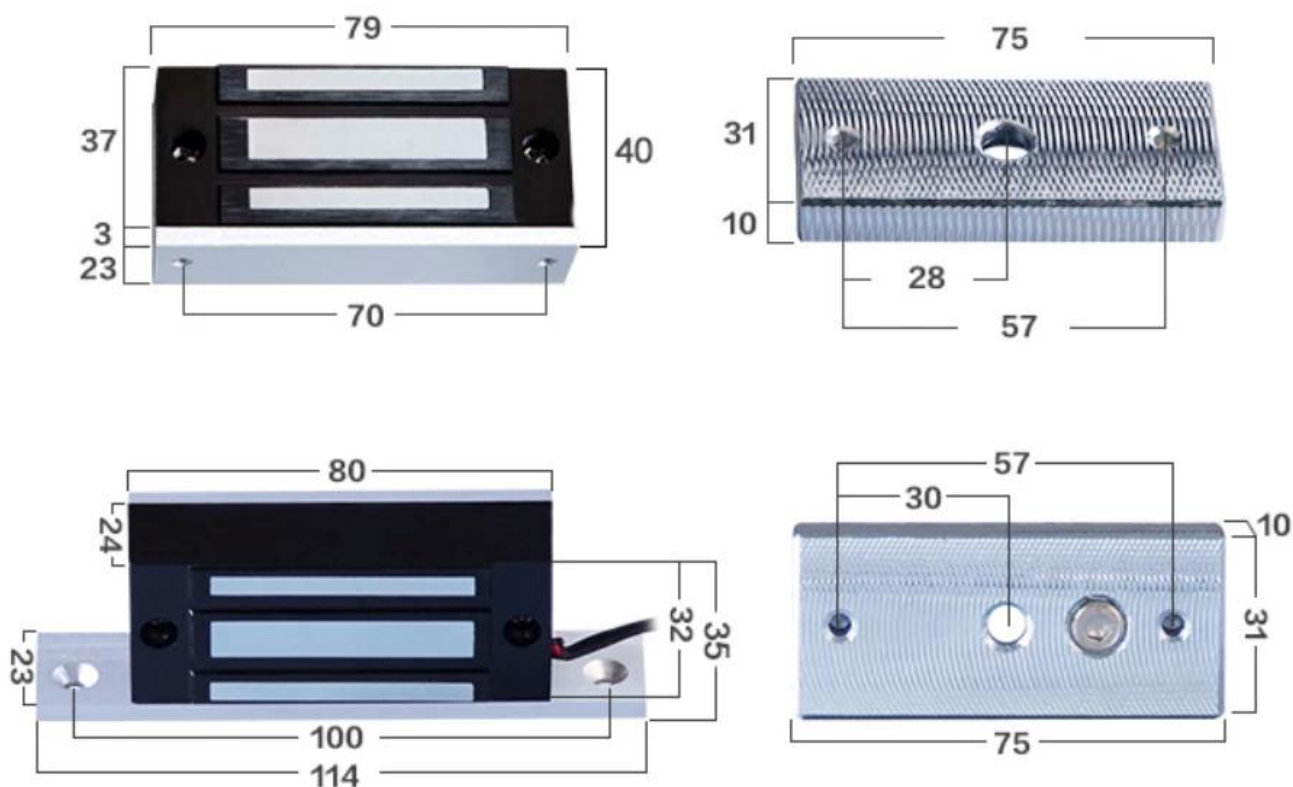

## 100LBs 60kg 12V Small Electromagnetic Lock

Model No.	Dimension	Quantity/Carton	Gross Weight	Carton Size
ACM-Y60 12V	79x40x23mm	50pcs	26.8KG	56x24x22cm
ACM-Y60 24V			26.8KG	

## Quality Warranty

- Warranty Service will be honored if the damage is not caused by human, ACM Goldbridge provides 2 years warranty for relative products.
- On the contrary, ACM Goldbridge will cahрге extra if repair.
- More information, please browse our service center.

## Instalation Diagram

# STANDARD INSTALLATION STEPS

Professional guidance, Rest assured

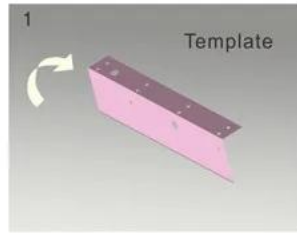

1 Fold the plate to 90° .

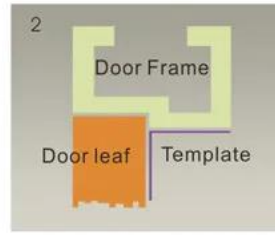

2 Close the door first, then place the upper side of template on door frame, while adjust the left side next to the door leaf.

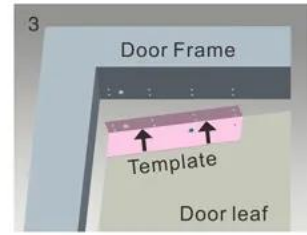

3 Mark screw positions of armature plate and magnetic lock on door leaf and door frame respectively.



4 Drill holes based on the marked positions.

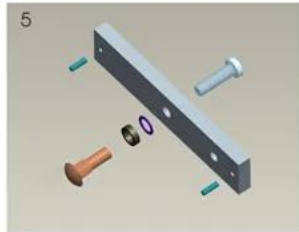

5 Make a combination based on the picture.

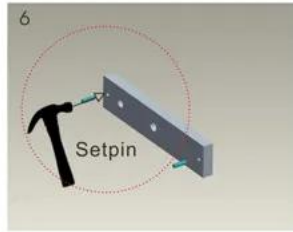

6 Strike the pin into the armature plate slightly (to avoid movement).

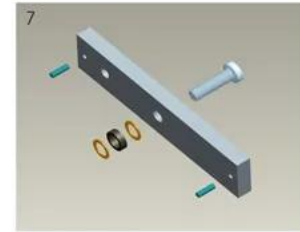

7 Make a combination based on the picture (add washer accordingly). The rubber ring must be added.

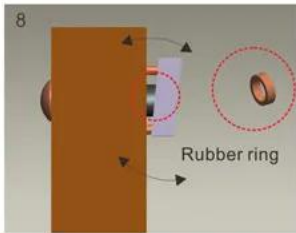

8 Place the rubber ring between armature plate and door leaf.



9 Use Allen key to remove the mounting plate from lock body.

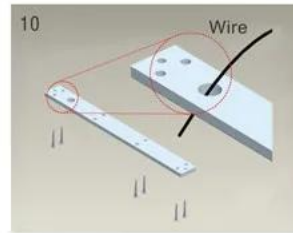

10 Fix the mounting plate on the door frame according to the holes drilled earlier.

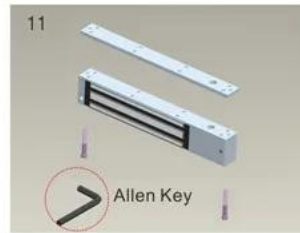

11 Use Allen key to screw the lock body on the mounting plate.

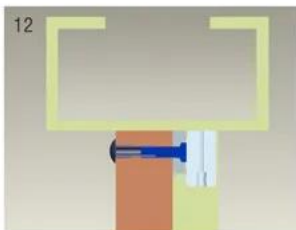

12 Close the door to test holding force. The angle between armature plate and magnetic lock can be adjusted by adding or reducing washers.

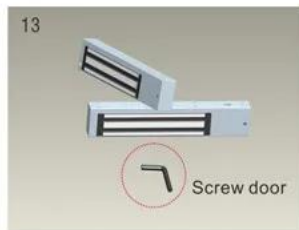

13 After all the appropriate procedures, the holding force can be maximized. Finally, fix the tamper screw.

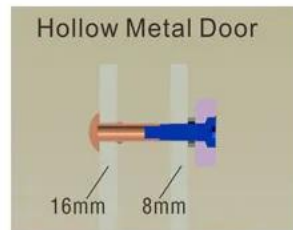

Hollow Metal Door  
Drill a hole  
Inside: Diameter is 8mm  
Outside: Diameter is 16mm

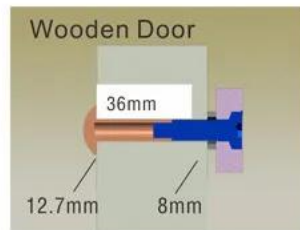

Wooden Door  
Drill a hole  
Inside: Diameter is 8mm  
Outside: Diameter is 12.7mm

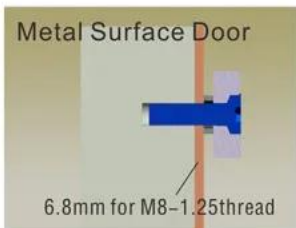

Metal Surface Door  
Inside: Drill a hole  
diameter is 8mm folding  
the plastic straight pin

## Notice:

Thickness of Door Leaf:

350LBS: 44mm

600LBS: 50mm

800LBS: 48mm

1200LBS: 46mm

## Packing & Delivery

### Shipping Way

We have strong cooperation with DHL, FEDEX, TNT, UPS, EMS, Forwarder by SEA and By AIR  
You also can choose your own shipping forwarder.

### Packaging

Magnetic Lock packaging: 1unit per box, 5pcs per carton,  
Carton size : 35\*30\*16cm , Gross Weight :25kg.





You may need



### ACM-Y280N

Backplate magnetic lock  
(280kgs/600lbs) Suitable For: Wooden  
Door, Glass Door, Metal Door, Fire|  
Proof Door

## ACM-Y180

Surface mounted (180kg/300lbs)  
magnetic lock 2Bolts Fail safe.Suitable  
For: Wooden Door, Glass Door, Metal  
Door, Fire Proof Door.

## ACM-Y280

280kg(600lbs) Single Door magnetic  
Lock Suitable For: Wooden Door, Glass  
Door, Metal Door, Fire Proof Door.



## ACM-Y280-L



L Bracket for 280kg/350kg Magnetic  
Lock

### **ACM-Y180ZL**

ZL Bracket for 180kg/300lbs Magnetic  
Lock

### **ACM-Y280-ZL**

ZL Bracket for 280Kg/350Kg Magnetic  
Lock

## **Our Service**

- 1, Any inquires will be replied within 24 hours
- 2, Professional manufacturer and supplier, Welcome to visit our website and our factory
- 3, OEM/ODM Available
- 4, High quality, fashin desing, reasonable & competitive price, fast lead time
- 5, After-sale Service :
  - 1), All products will have been strictly quality checked in house before packing
  - 2), All products will be well packed before shipping
  - 3), All our products have 2-3 year warranty if the damage is not caused by human
- 6, Faster delivery : Around 1~ 5 days for sample order, 7~30 days for bulk order
- 7, Payment : You can pay for the order via : T/T, Western Union, Paypal.
- 8, Shipping: We have strong cooperation with DHL, FEDEX, TNT, UPS, EMS, Forwarder by SEA and By AIR, You also can choose your own shipping forwarder.

## **FAQ**

### **Q: 1. How can I place an order?**

A: Please list your requirement to us via email. Then we will send the offer to you at earliest time,after order confirmation, we will arrange production ASAP.

### **Q: 2.What about the payment and shipment?**

A: TT/T ,Paypal, Western Union.

Clients can choose by sea, air or express(DHL, FedEx, TNT UPS etc.)

### **Q: 3. How can i get a sample to check your quality?**

A:We could provide free sample to you, and the freight cost payed by you.

### **Q:4. How long can I expect to get the samples?**

A: It depends on the quantity. Normally 3-7 days for 5000pcs and 7-15 days for 100,000pcs

### **Q:5. Can your products be customized?**

A: Almost all of your products are customized ,including the materia, size, thickness and printing. OEM orders are highly welcome.

### **Q:6.Are you a trading company or factory?**

We are the one of the biggest manufacturer of RFID cards/NFC tags/RFID keybod /RFID wristband,rfid reader and access control products in China more than 20 years.