



## **Long type Electric Strike safety door lock**

ACM-Y132 is European Long type Electric Strike Lock with adjustable mode for Fail locked & Fail Unlocked. It works with magnetic force generated by electromagnetic field for locking/unlocking

P  
a  
r  
a  
m  
e  
t  
e  
r  
i  
a  
l  
D  
e  
s  
c  
r  
i  
p  
t  
i  
o  
n

F  
a  
i  
t  
S  
a  
e  
e  
S  
t  
a  
i  
k  
e  
S  
s  
S  
t  
e  
r  
e  
H  
k  
g  
d  
i  
n  
g  
F  
o  
r  
c  
e

D  
O  
C  
U  
M  
E  
N  
T  
S  
O  
R  
D  
E  
R  
D  
C  
2  
4  
V  
)  
E  
M  
A  
I  
L  
N  
U  
M  
B  
E  
R  
S  
O  
R  
D  
E  
R  
;  
2  
M  
A  
(  
Y  
-  
1  
3  
2  
N  
C  
)

F  
a  
i  
t  
S  
e  
e  
u  
r  
e  
(  
Y  
-  
1  
3  
2  
N  
O  
)  
;  
F  
a  
i  
l  
S  
a  
f  
e  
(  
Y  
-  
1  
3  
2  
N  
C  
)

~~W~~  
a  
i  
d  
a  
b  
D  
e  
~~F~~  
o  
r  
M  
e  
t  
a  
l  
D  
o  
o  
r  
,  
P  
V  
C  
D  
o  
o  
r  
~~W~~  
i  
r  
h  
i  
n  
e  
~~T~~  
C  
m  
p  
e  
r  
a  
t  
u  
r  
e

S  
#  
r  
#  
a  
b  
c  
e  
T  
A  
m  
p  
e  
t  
F  
t  
u  
r  
e  
O  
P  
S  
f  
n  
o  
n  
n  
g  
H  
n  
h  
e  
n  
s  
t  
M  
g  
)

F  
a  
c  
t  
o  
r  
y  
S  
e  
r  
v  
i  
c  
e  
S  
o  
l  
u  
t  
i  
o  
n  
M  
o  
d  
e  
r  
n  
A  
p  
p  
l  
i  
c  
a  
t  
i  
o  
n  
s

## Product Advanatge

ACM-Y132 is European Long type Electric Strike Lock with adjustable mode for Fail locked & Fail Unlocked. It works with magnetic force generated by electromagnetic field for locking/unlocking. particularly with short circuit protection. This model has 2 working modes: Power-to-open & Power-to-lock. It is made of high-quality aluminum for high hardness, corrosion resistance & anti-deformation. It is suitable for all types of wooden door, metal door, PVC door etc.

[Detailed Images , OEM/ODM available](#)



ACM-Y131 NO/NC is the electric strike with long faceplate. It has two modes: A fail safe electric strike needs power to keep it locked. A fail secure electric strike stays locked even without power. Electric strikes come in many varieties.

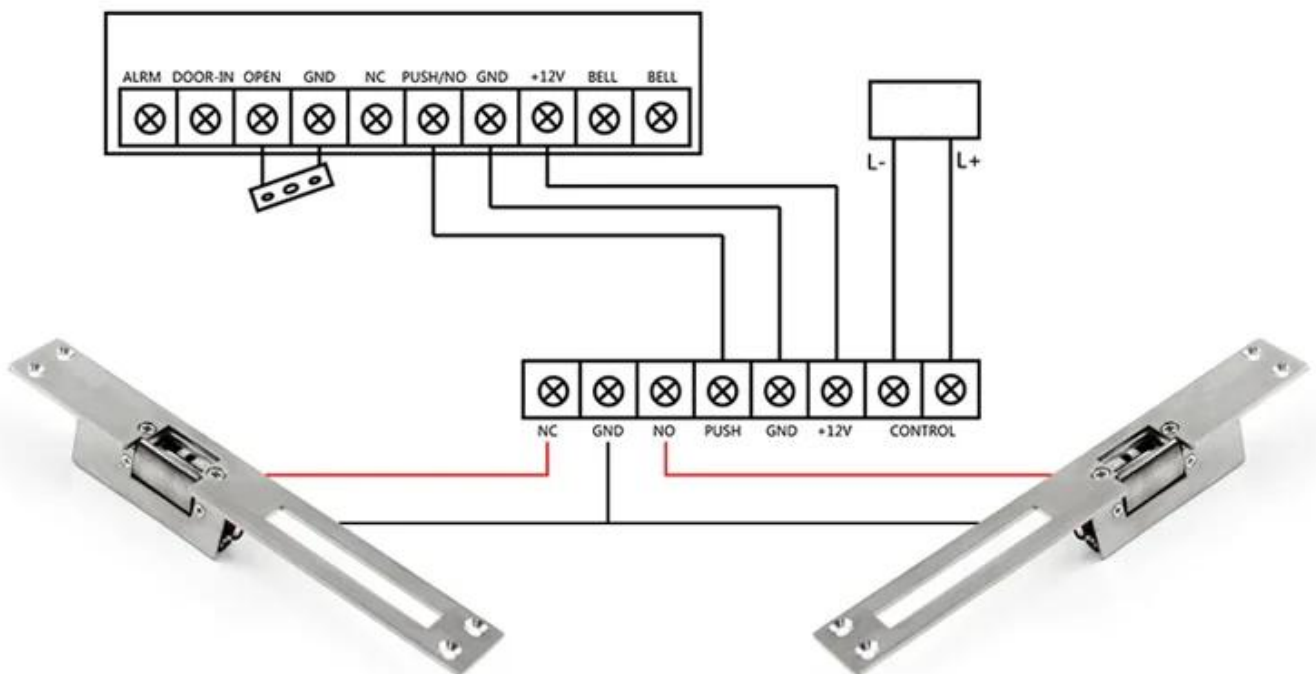

More Features and Functions for This Stainless Steel Electronic Stripe (NC/NO)



### 03 Low temperature design

less heat is safe and reliable.



### 04 Low Power Design

Rated Operating Voltage: DC 12V  
Current: 240mA(Fail-secure) /  
120mA(Fail-safe)

### 05 High-quality Aluminum Case

Made of high-quality aluminum for high hardness,  
corrosion resistance & anti-deformation.



## Quality Warranty

- Warranty Service will be honored if the damage is not caused by human, ACM Goldbridge provides 2 years warranty for relative products.
- On the contrary, ACM Goldbridge will charge extra if repair.
- More information, please browse our service center.

## Installation Diagram

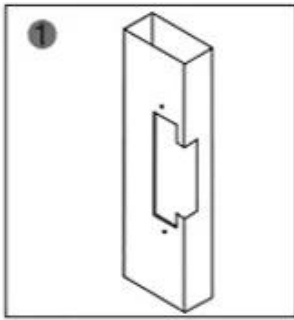

1 Cutting according to the size of the electric lock

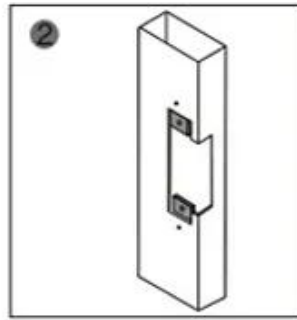

2 Insert extension plate

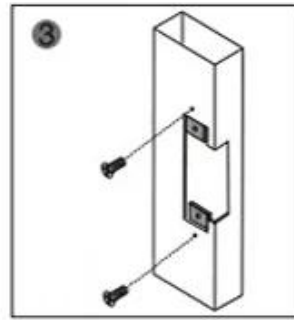

3 Fix extension plate

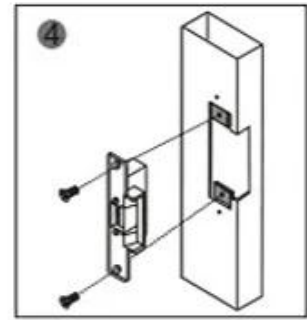

4 After installed, power on and test it

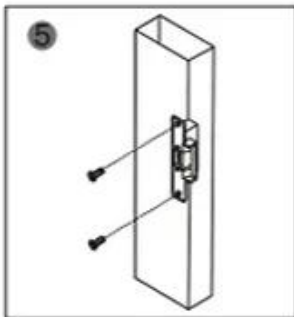

5 Fix strike lock

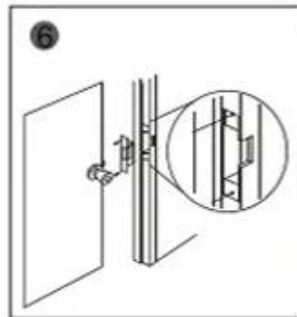

6 Finish

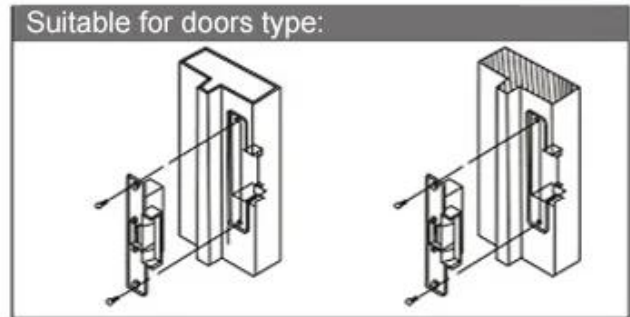

Metal door frame

Wooden door frame

## Packing & Delivery

### Shipping Way

We have strong cooperation with DHL, FEDEX, TNT, UPS, EMS, Forwarder by SEA and By AIR  
You also can choose your own shipping forwarder.

### Packaging

Magnetic Lock packaging: 1unit per box, 30pcs per carton,  
Carton size : 54.5\*20\*30.5cm , Gross Weight :11.7kg. 50 cartons per pallet



## Related Products

[Click here to order and have your FREE SAMPLE in 3 days!!!](#)

We are professional comprehensive security access control products supplier with 20 years experience, we make sure to offer the best solution of access control system solution! So, send your inquiry details in the below, click "Send" now!

We are looking forward to forming successful business relationships with new clients around the world in the future.



### **ACM-Y130**

Standard Type electronic Stripe  
(NC/NO) For Wooden Door, Metal

Door,PVC Door



### **ACM-Y131**

Stainless steel electronic Stripe  
(NC/NO) For Wooden Door, Metal  
Door,PVC Door



### **ACM-Y132**

280kg(600lbs) Single Door magnetic  
Lock Suitable For: Wooden Door, Glass  
Door, Metal Door, Fire Proof Door.

**You may need**

[Click here to order and have your FREE SAMPLE in 3 days!!!](#)

We are professional comprehensive security access control products supplier with 20 years experience, we make sure to offer the best solution of access control system solution! So, send your inquiry details in the below, click "Send" now!

We are looking forward to forming successful business relationships with new clients around the world in the future.



### **ACM-Y280**

Surface mounted magnetic lock(280kg/600lbs)



### **ACM-Y100S**

ELECTRIC DROP BOLT LOCK  
Time-delay &NO/NC Power to unlock



### **ACM-Y066**

Intelligent Smart Lock (motor lock)  
Lock size: 130x98x41mm Working

[Whole Set Solution Door Access Control](#)



### ACM-WEG02

Network 2 Door Door Access Control Panel(RS232, RS485 Or TCP/IPCommunication)



### ACM-K2A

No touch Door Release Exit Button,K2A: 115\*40mm ;K2B: 86\*86mm



### ACM-Y806-3A

Backup Power Supply 12V/3A



### **ACM-Y280**

Surface mounted magnetic lock(280kg/600lbs)



### **ACM-26X**

125Khz wiegand 26 /34  
Reader,Size:115mm×75.5mm×16.8m  
m



### **ACM-EMI-S**

125Khz EM Proximity Card