

Door Access Control

Tuya WiFi Door Exit Button Wireless Release Push Switch For Electronic Door Lock Sensor Access Control System APP Remote Control

Description:

1. If this switch needs to realize the mobile phone remote control function, it need provide a 12vDC regulated power supply for the switch.
- 2 The switch need be installed in an environment with WiFi coverage.
- 3 Avoid high-voltage power supply or strong magnetic interference in the installation environment.

RF433 remote control

The equipment is installed in a weak current system with a WF environment, and the wireless switch can be remotely controlled within a certain distance.

APP remote control

Simple and intuitive switch button·Switch status is synchronized with the mobile phone in real time

The device is installed in a weak current system with a WF environment, and the mobile phone can remotely control it in any place where there is a signal

Smart cloud sharing

The mobile phone paired with the module for the first time is the mobile phone with the primary account, which can manage the shared users. Support one mobile phone to control multiple devices, support multiple mobile phones to control one device.

Specifications:

Product Name: Type 86 Smart Access Control Switch

Structure: fire-resistant fuel mixed resin

Product life: 100,000 times of aging test

Power supply mode: DC12V

Product specifications: 86X86X22mm

Working temperature: -10°C- 55°C (14-131°F)

Product name: wireless switch

1. Working frequency: 433.92MHz
2. Working voltage: DC 3V
3. Transmitting power: <10mW
4. Remote control distance: <100 meters (indoor distance)
5. Working temperature: -10°C~ 70°C
6. Size: 86*86*15.5 (mm)
7. Standard battery, CR2032 battery

Package Included:

1*switch(Optional)

Notes:

1. If this switch needs to realize the mobile phone remote control function, it need provide a 12vDC regulated power supply for the switch.
- 2 The switch need be installed in an environment with WiFi coverage.
- 3 Avoid high-voltage power supply or strong magnetic interference in the installation environment.

Wi-Fi Mini smart Interconnect



Works with
Tuya



Works with
SmartLife



Google Home



amazon alexa

16A



APP
Control



Voice
Control



Timing
Countdown

Product Parameter

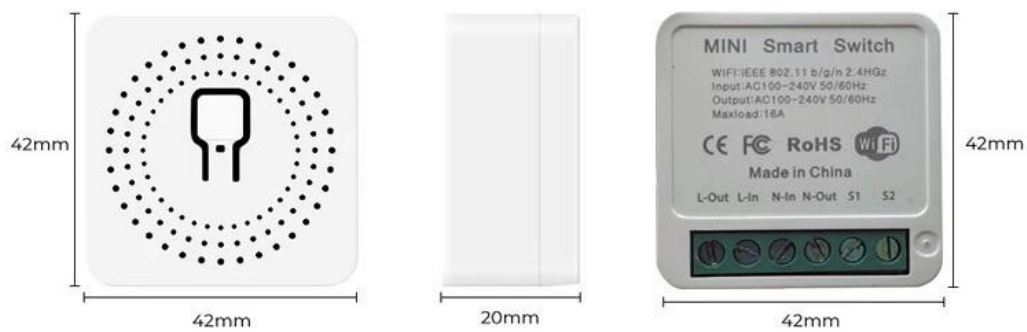

Color:	White
Output:	AC 100-240V 50/60HZ
Input:	AC 100-240V 50/60Hz
WiFi:	IEEE 802.11b/g/n
Material:	PC V-0
Start method:	Touch/Mobile APP/Voice Speaker
Certified product:	CE FCC ROHS



Wifi/ Remote Control



Timer and Schedule



Alexa/Google Voice Control



scene setting



APP Control



Device Sharing

应用程序控制 App control

Smart Life app can do an individual Control or group control
智能生活 app 可以进行单个控制，也可以进行多个控制



Easy to install

Can be placed behind the switch



Put in the box



No need to climb stairs



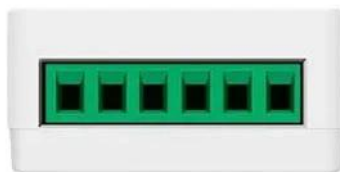
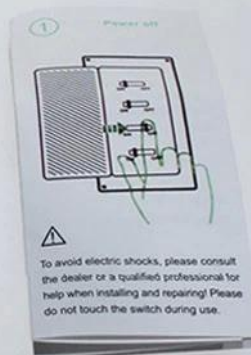
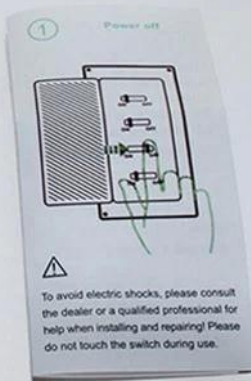

Related Products

Door Release Exit Button



— Door Release Exit Button —

Factory Wholesale & Door Release Exit Button



Application

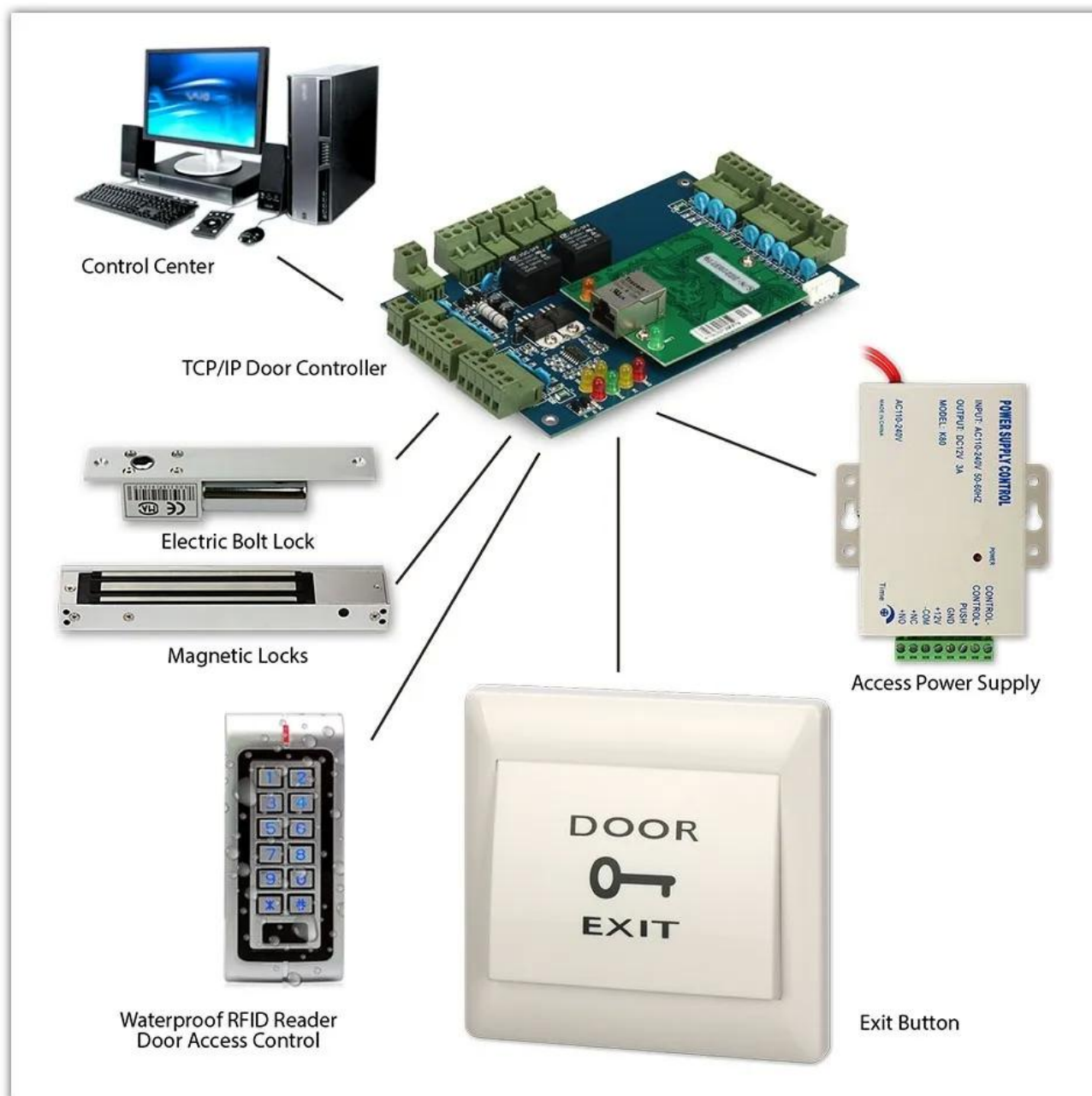

Packing & Delivery

Unit Type: piece

Package Weight: 0.3kg

Package Size: 10cm x 10cm x 8cm



Our Service

- 1, Any inquires will be replied within 24 hours
- 2, Professional manufacturer and supplier, Welcome to visit our website and our factory
- 3, OEM/ODM Available
- 4, High quality, fashin desing, reasonable & competitive price, fast lead time
- 5, After-sale Service :
 - 1), All products will have been strictly quality checked in house before packing
 - 2), All products will be well packed before shipping
 - 3), All our products have 2-3 year warranty if the damage is not caused by human
- 6, Faster delivery : Around 1~ 5 days for sample order, 7~30 days for bulk order

7, Payment : You can pay for the order via : T/T, Western Union, Paypal

8, Shipping: We have strong cooperation with DHL, FEDEX, TNT, UPS, EMS, Forwarder by SEA and By AIR, You also can choose your own shipping forwarder.

FAQ

Q: 1. How can I place an order?

A: Please list your requirement to us via Email. Then we will send the offer to you at earliest time, after order confirmation, we will arrange production ASAP.

Q: 2. What about the payment and shipment?

A: T/T, Paypal, Western Union.

Clients can choose by sea, air or express (DHL, FedEx, TNT UPS etc.)

Q: 3. How can I get a sample to check your quality?

A: We could provide free sample to you, and the freight cost paid by you.

Q: 4. How long can I expect to get the samples?

A: It depends on the quantity. Normally 3-7 days for 5000 pcs and 7-15 days for 100,000 pcs

Q: 5. Can your products be customized?

A: Almost all of your products are customized, including the material, size, thickness and printing. OEM orders are highly welcome.

Q: 6. Are you a trading company or factory?

We are one of the biggest manufacturers of RFID cards/NFC tags/RFID keyfobs/RFID wristbands/RFID reader and access control products in China more than 20 years.