

## Product Description



### **Long type adjustable fail safe and fail secure electronic strike latch lock**

ACM-Y133 is European Electric Strike Lock with adjustable mode for Fail locked & Fail Unlocked. It works with magnetic force generated by electromagnetic field for locking/unlocking

P  
a  
P  
a  
m  
d  
t  
e  
t  
D  
a  
s  
a  
m  
è  
p  
è  
r  
o  
n

Hold it for me

D  
C  
1  
2  
V  
(  
N  
~~W~~  
e  
h  
O  
n  
g  
e  
r  
D  
C  
2  
4  
V  
)  
C  
u  
~~#~~  
m  
A  
n  
t

F  
a  
i  
l  
S  
e  
c  
u  
r  
e  
(  
Y  
-  
1  
3  
E  
N  
O  
t  
μ  
F  
a  
i  
l  
S  
a  
f  
e  
(  
Y  
-  
1  
3  
3  
N  
C  
)

W  
o  
o  
d  
e  
n  
D  
o  
o  
S  
n  
i  
M  
a  
b  
h  
h  
h  
D  
o  
o  
r  
,  
P  
V  
C  
D  
o  
o  
r  
S  
u  
r  
f  
a  
W  
c  
r  
e  
t  
h  
e  
i  
m  
p  
r  
e  
s  
s  
e  
r  
C  
a  
t  
u  
r  
e

Suit (a+b+c+d+e+f+g+h+i+j+k+l+m+n+o+p+q+r+s+t+u+v+w+x+y+z) = 0

F  
a  
P  
a  
p  
h  
a  
e  
d  
H  
b  
a  
e  
l  
n  
g  
B  
u  
F  
h  
h  
e  
b  
u  
b  
M  
O  
V  
W  
e  
a  
g  
g  
t

## Product Advanatge

ACM-Y133 is European Electric Strike Lock with adjustable mode for Fail locked & Fail Unlocked. It works with magnetic force generated by electromagnetic field for locking/unlocking. particularly with short circuit protection. This model has 2 working modes: Power-to-open & Power-to-lock. It is made of high-quality aluminum for high hardness, corrosion resistance & anti-deformation. It is suitable for all types of wooden door, metal door, PVC door etc.

Detailed Images , OEM/ODM available









Long type adjustable fail safe and fail secure electronic strike latch lock

**01 Strong and Durable**

Stainless steel panels, stable and durable.

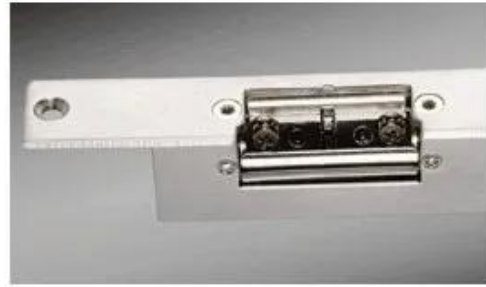

**02 Metal Shell**

Designed for Metal Frame drill a hole, then install it directly.

**03 Special Design**

Adjust Lock-tongue to NO style



More Features and Functions for This Stainless Steel Electronic Stripe (NC/NO)



#### 04 Low Power Design

#### 05 Rugged combination, Security Guarantee



1. Stainless steel faceplate, Anti-strike,  
Stronger protection.



2. Stainless steel tongue.



3. The metal shell paint high hardness,  
corrosion resistance & anti-deformation

## Quality Warranty

- Warranty Service will be honored if the damage is not caused by human, ACM Goldbridge provides 2 years warranty for relative products.
- On the contrary, ACM Goldbridge will charge extra if repair.
- More information, please browse our service center.

## Instalation Diagram

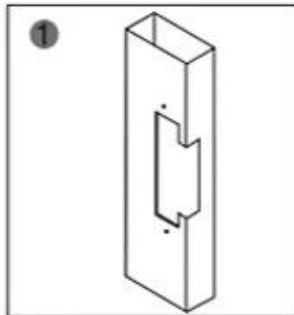

1 Cutting according to the size of the electric lock

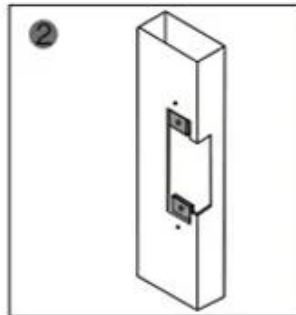

2 Insert extension plate

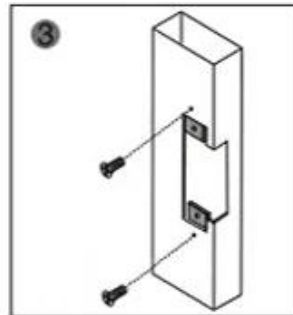

3 Fix extension plate

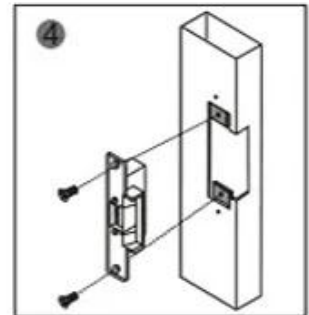

4 After installed, power on and test it

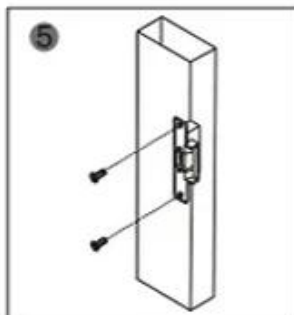

5 Fix strike lock

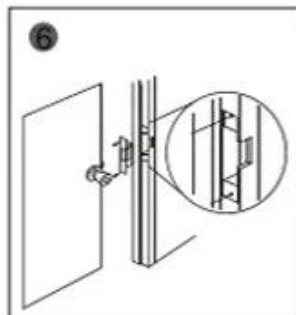

6 Finish

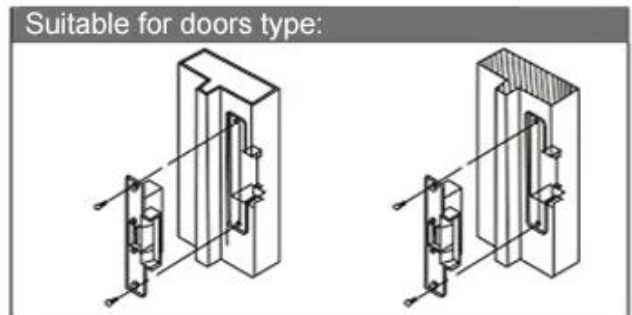

Metal door frame

Wooden door frame

## Packing & Delivery

### Shipping Way

We have strong cooperation with DHL, FEDEX, TNT, UPS, EMS, Forwarder by SEA and By AIR  
You also can choose your own shipping forwarder.

### Packaging

Bolt Lock packaging: 1unit per box, 60pcs per carton,



You may need





### **ACM-Y130**

Standard Type electronic Stripe  
(NC/NO) For Wooden Door, Metal  
Door,PVC Door

### **ACM-Y131**

Stainless steel electronic Stripe  
(NC/NO) For Wooden Door, Metal  
Door,PVC Door

### **ACM-Y132**

280kg(600lbs) Single Door magnetic  
Lock Suitable For: Wooden Door, Glass  
Door, Metal Door, Fire Proof Door.







### **ACM-Y280**

Surface mounted magnetic  
lock(280kg/600lbs)

### **ACM-Y100S**

ELECTRIC DROP BOLT LOCK  
Time-delay &NO/NC Power to unlock

### **ACM-Y066**

Intelligent Smart Lock (motor lock)  
Lock size: 130x98x41mm Working

## **Our Service**

- 1, Any inquires will be replied within 24 hours
- 2, Professional manufacturer and supplier, Welcome to visit our website and our factory
- 3, OEM/ODM Available
- 4, High quality, fashin desing, reasonable & competitive price, fast lead time
- 5, After-sale Service :
  - 1), All products will have been strictly quality checked in house before packing
  - 2), All products will be well packed before shipping
  - 3), All our products have 2-3 year warranty if the damage is not caused by human
- 6, Faster delivery : Around 1~ 5 days for sample order, 7~30 days for bulk order
- 7, Payment : You can pay for the order via : T/T, Western Union, Paypal.
- 8, Shipping: We have strong cooperation with DHL, FEDEX, TNT, UPS, EMS, Forwarder by SEA and By AIR, You also can choose your own shipping forwarder.



## FAQ

**Q: 1. How can I place an order?**

A: Please list your requirement to us via email. Then we will send the offer to you at earliest time, after order confirmation, we will arrange production ASAP.

**Q: 2. What about the payment and shipment?**

A: Trade Assurance and T/T, Paypal, Western Union.

Clients can choose by sea, air or express (DHL, FedEx, TNT UPS etc.)

**Q: 3. How can I get a sample to check your quality?**

A: We could provide free sample to you, and the freight cost paid by you.

**Q: 4. How long can I expect to get the samples?**

A: It depends on the quantity. Normally 3-7 days for 5000 pcs and 7-15 days for 100,000 pcs

**Q: 5. Can your products be customized?**

A: Almost all of your products are customized, including the material, size, thickness and printing. OEM orders are highly welcome.

**Q: 6. Are you a trading company or factory?**

We are one of the biggest manufacturers of RFID cards/NFC tags/RFID keyfobs/RFID wristbands/RFID reader and access control products in China more than 20 years.