



frameless glass door electric bolt lock optional bracket

Y-500U is a fail safe electric bolt .with Door status Signal Output ,suitable for glass door, wooden door, metal door . We supply integrity equipment to collocate with fully frame less glass door, swing-in door and so on. low temperature design.

P
a
P
a
m
d
t
e
t
D
a
s
a
m
e
p
e
i
o
n

F
e
h
S
a
f
e

2
5
I
x
3
3
5
6
W
X
I
4
H
t
C
e
m
m
)

9
L
x
2
5
5
W
r
x
2
K
H
e
(
m
m
)

V
D
C
1
2
G
e

S
t
a
r
Ø
C
m
A
r
e
n
t
S
t
a
n
d
b
Ø
m
A
r
r
e
n
t
S
o
l
i
d
B
o
l
t
t
H
K
g
d
i
n
g
F
o
r
c
e

L
o
c
~~E~~
t
~~g~~
l
i
n
h
d
~~e~~
~~s~~
~~S~~
~~h~~
a
e
e
r
i
a
l
I
n
d
u
c
t
i
~~o~~
m
~~m~~
i
s
t
a
n
c
e

W
o
o
d
d
e
n
D
o
o
r
,
G
l
a
s
s
D
o
o
r
I
r
o
n
's
M
e
t
a
l
D
o
o
r
,
P
V
C
D
o
o
r
r

L
i
g
h
t
o
n
i
n
d
i
c
a
t
e
s
l
o
c
k
e
d

L
E
D
g
h
t
o
f
f
i
n
d
i
c
a
t
e
s
u
n
l
o
c
k
e
d

L
 S
 W
 H
 I
 T
 T
 H
 E
 F
 A
 H
 E
 A
 R
 I
 N
 G
 S
 A
 R
 E
 A
 L
 W
 A
 Y
 S
 I
 N
 T
 H
 E
 C
 O
 U
 R
 T
 O
 F
 J
 U
 S
 T
 I
 C
 E
 S
 .
 (

Product Advantage

1. Low Temperature, safe & Durable.
2. Low Power, Environmental Protection.
3. Special photoelectricity control,three steps current application.
4. Long Life with 500000 cycles.
5. MOV Provides Reverse Current Protection.
6. Superior Strength Aluminium Alloy,Solid Stainless Steel Bolt.
7. Double protection for loading current.
8. Photoelectricity Control,Low Temperature,

A:The Low Current is Changed immediately;

B:When door frame doesn't coincide with doorleaf ,door leaf against the bolt,then the electricbolt will start the low-power function to bring low temperature.

C:The Photoelectricity Control Technology, prevent the machanical defect.

Detailed Images , OEM/ODM available



UW-500U-LED

Feature: Fail Safe
Face Plate: 185Lx25.7Wx37H(mm)
Bolt: 16(length)x12.7(diameter)(mm)
Voltage: DC12V
Start Current: 960mA

Standby Current: 180mA
Solid Bolt : polishing housing, 1000Kg Holding Force
Suitable For: Electric Bolt For Narrow Door
Signal Output: Door status Output,NO/COM
Surface Temp: Low Temperature
Induction Distance: 8mm
Special Designed: Tested to 500000 operations
Plate material: Stainless Steel
Weight: 1.2kg

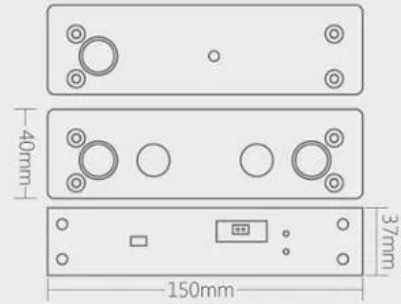

Product show with different direction



Installation Diagram

STANDARD INSTALLATION STEPS

Professional guidance, Rest assured

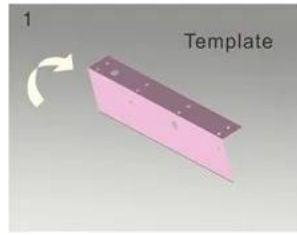
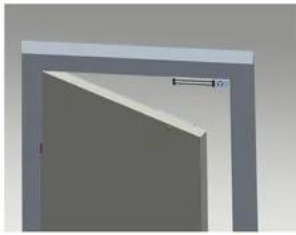

1 Fold the plate to 90° .

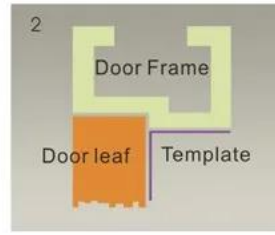

2 Close the door first, then place the upper side of template on door frame, while adjust the left side next to the door leaf.

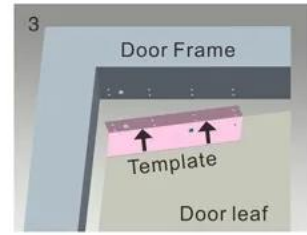

3 Mark screw positions of armature plate and magnetic lock on door leaf and door frame respectively.



4 Drill holes based on the marked positions.

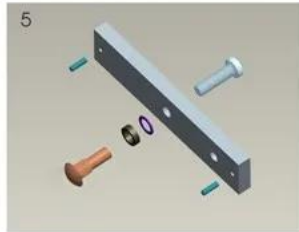

5 Make a combination based on the picture.

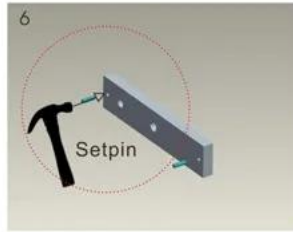

6 Strike the pin into the armature plate slightly (to avoid movement).

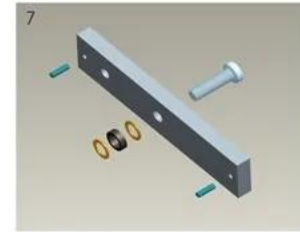

7 Make a combination based on the picture (add washer accordingly). The rubber ring must be added.

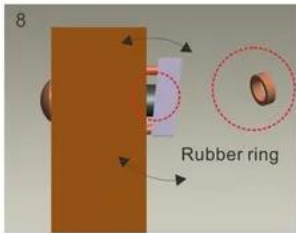

8 Place the rubber ring between armature plate and door leaf.



9 Use Allen key to remove the mounting plate from lock body.

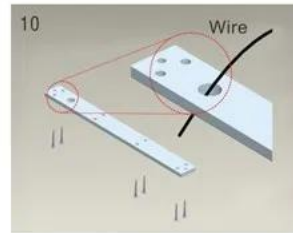

10 Fix the mounting plate on the door frame according to the holes drilled earlier.



11 Use Allen key to screw the lock body on the mounting plate.

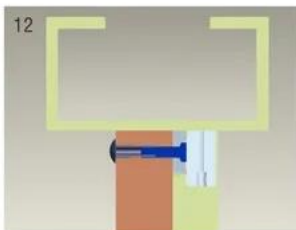

12 Close the door to test holding force. The angle between armature plate and magnetic lock can be adjusted by adding or reducing washers.

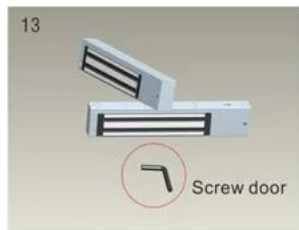

13 After all the appropriate procedures, the holding force can be maximized. Finally, fix the tamper screw.

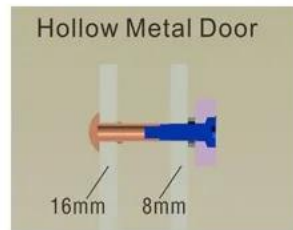

Hollow Metal Door
Drill a hole
Inside: Diameter is 8mm
Outside: Diameter is 16mm

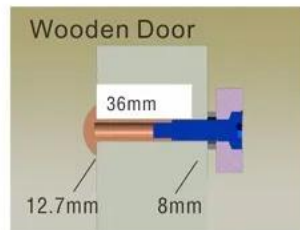

Wooden Door
Drill a hole
Inside: Diameter is 8mm
Outside: Diameter is 12.7mm

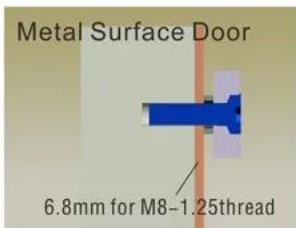

Metal Surface Door
Inside: Drill a hole
diameter is 8mm folding
the plastic straight pin

Notice:

Thickness of Door Leaf:

350LBS: 44mm

600LBS: 50mm

800LBS: 48mm

1200LBS: 46mm

Packing & Shipping

Shipping Way

We have strong cooperation with DHL, FEDEX, TNT, UPS, EMS, Forwarder by SEA and By AIR
You also can choose your own shipping forwarder.

Packaging

Bolt Lock packaging: 1unit per box, 20pcs per carton,
Carton size :52*29*12cm , Gross Weight :14kg. 50 cartons per pallet



Related Products

Click here to order and have your FREE SAMPLE in 3 days!!!

We are professional comprehensive security access control products supplier with 20 years experience, we make sure to offer the best solution of access control system solution! So, send your inquiry details in the below, click "[Send](#)" now!

We are looking forward to forming successful business relationships with new clients around the world in the future.



ACM-Y100S 2PIN

ELECTRIC DROP BOLT LOCK

Standby 100MA / working

900MA Power to unlock, 2PIN

ACM-Y500A

ELECTRIC DROP BOLT LOCK

Time-delay,Feedback Signal ,NC

ACM-Y100S 5PIN

ELECTRIC DROP BOLT LOCK

Low temperature time-delay,feedback
signalPower to unlock, 5PIN

You May Need



ACM-Y280

Surface mounted magnetic
lock(280kg/600lbs)

ACM-Y100S

Stainless steel electronic Stripe
(NC/NO) For Wooden Door, Metal
Door,PVC Door

ACM-Y066

Intelligent Smart Lock (motor lock)
Lock size: 130x98x41mmWorking

Bracket Need for Door Deadbolt Lock



ACM-Y700

Stainless Steel Bracket for Frameless
Glass Door

ACM-Y600

Stainless Steel Bracket is for
Frameless Glass Door

ACM-Y601

Aluminium Bracket for frameless Glass
Door

Whole Set Solution Door Access Control



ACM-WEG02

Network 2 Door Door Access Control
Panel(RS232, RS485 Or
TCP/IPCommunication)

ACM-K2A

No touch Door Release

ExitButton,K2A: 115*40mm ;K2B:
86*86mm

ACM-Y806-3A

Backup Power Supply 12V/3A



ACM-Y280

Surface mounted magnetic
lock(280kg/600lbs)

ACM-26X

125Khz wiegand 26 /34

Reader,Size:115mm×75.5mm×16.8mm

ACM-EMI-S

125Khz EM Proximity Card

Click here to order and have your FREE SAMPLE in 3 days!!!

We are professional comprehensive security access control products supplier with 20 years experience, we make sure to offer the best solution of access control system solution! So, send your inquiry details in the below, click "[Send](#)" now!

We are looking forward to forming successful business relationships with new clients around the world in the future.

Our Service

- 1, Any inquires will be replied within 24 hours
- 2, Professional manufacturer and supplier, Welcome to visit our website and our factory
- 3, OEM/ODM Available
- 4, High quality, fashin desing, reasonable & competitive price, fast lead time
- 5, After-sale Service :
 - 1), All products will have been strictly quality checked in house before packing
 - 2), All products will be well packed before shipping
 - 3), All our products have 2-3 year warranty if the damage is not caused by human
- 6, Faster delivery : Around 1~ 5 days for sample order, 7~30 days for bulk order
- 7, Payment : You can pay for the order via : T/T, Western Union, Paypal, Ali trade assurance
- 8, Shipping: We have strong cooperation with DHL, FEDEX, TNT, UPS, EMS, Forwarder by SEA and By AIR, You also can choose your own shipping forwarder.

Quality Warranty

- Warranty Service will be honored if the damage is not caused by human, ACM Goldbridge provides 2 years warranty for relative products.
- On the contrary, ACM Goldbridge will cahрге extra if repair.
- More information, please browse our service center.

Our Company

ACM Shenzhen Goldbridge industrial company

As a one of leading manufactuer and exporter of RFID and access control and electric door locks products in China , We have been in this field for 20 years already . We have rich production and exportation experience on RFID access control locks products . Our strength products are : RFID card , RFID keyfob , RFID wristband , RFID tag and various RFID reader, UHF long range reader, eletric door locks, . We are also the access control solution provider .

