



High quality Stainless Steel Electronic Cabinet Lock Mini Electric Bolt storage

The Y-302A Electric Cabinet Lock is designed to electronically secure cabinets and drawers.

The addition of a keypad or remote control of your choice provides true access control and convenience of use .

F
a
i
l
S
e
c
u
r
e
(
Y
-
1
3
F
E
N
O
t
u
F
a
i
l
S
a
f
e
(
Y
-
1
3
2
N
C
)
V
D
C
t
a
g
e
C
u
2
m
A
n
t

W
o
o
d
e
n
D
o
6
n
i
M
a
b
h
e
D
o
o
r
,
P
V
C
D
o
o
r
5
4
.
5
L
x
4
S
I
W
Z
x
e
2
8
H
(
m
m
)

S
u
i
t
a
b
l
4
T
e
h
p
C
r
a
t
u
r
e
C
G
B
A
e
h
%
W
e
l
g
h
t

Product Advantage

The Y-302A Electric Cabinet Lock is designed to electronically secure cabinets and drawers:

[Detailed Images , OEM/ODM available](#)



Using high quality iron as the main material , simple structure, easy installation, stable and durable performance .

The lock tongue is made of brass material . the power is retracted and the power is elected . the tongue lock stroke 7mm .

The internal copper coil is used for heating up and heat resistance . it is recommended that the power on time should be controlled at 0-10 seconds .





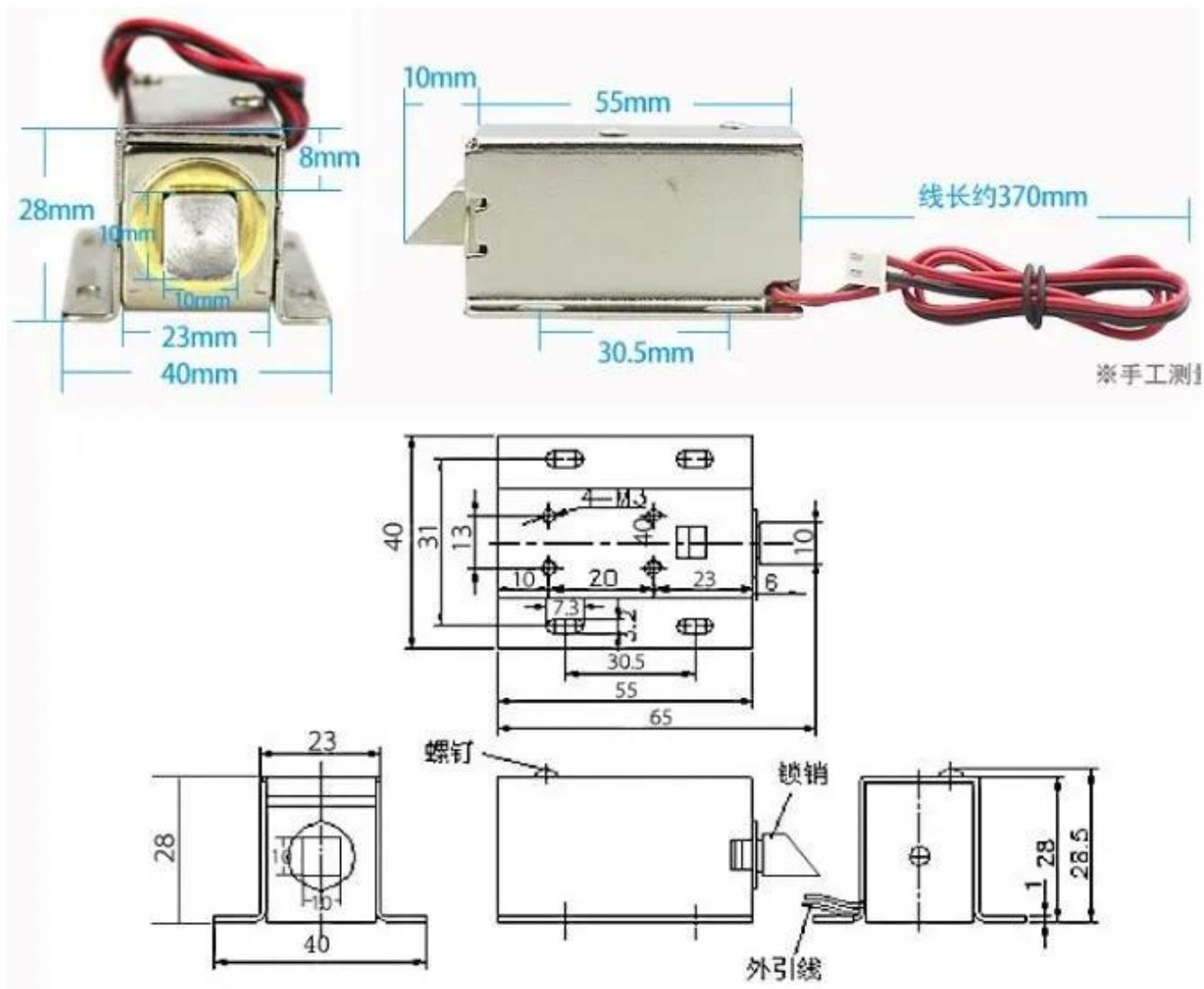

More Features and Functions for This Stainless Steel Electronic Stripe (NC/NO)

Instalation Diagram

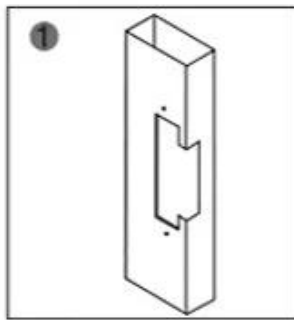

1 Cutting according to the size of the electric lock

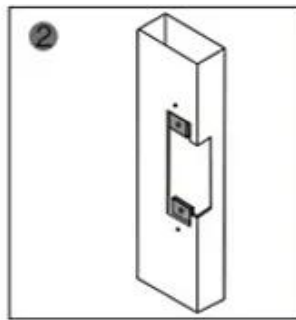

2 Insert extension plate

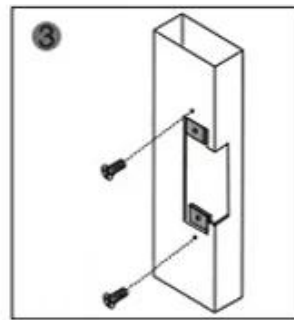

3 Fix extension plate

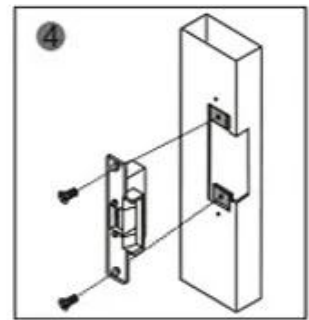

4 After installed, power on and test it

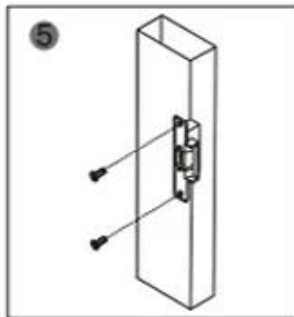

5 Fix strike lock

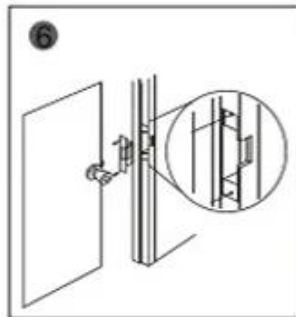

6 Finish

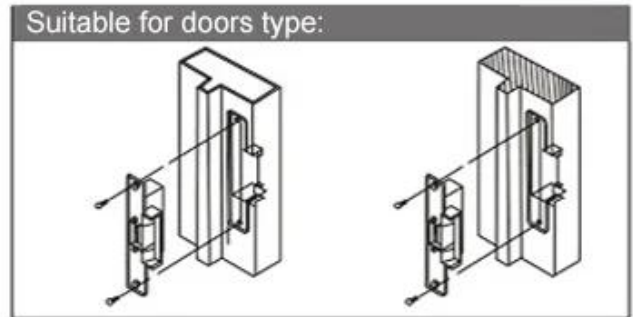

Suitable for doors type:

Metal door frame

Wooden door frame

Quality Warranty

- Warranty Service will be honored if the damage is not caused by human, ACM Goldbridge provides 2 years warranty for relative products.
- On the contrary, ACM Goldbridge will cahрге extra if repair.
- More information, please browse our service center.

Packing & Delivery

Shipping Way

We have strong cooperation with DHL, FEDEX, TNT, UPS, EMS, Forwarder by SEA and By AIR
You also can choose your own shipping forwarder.

Packaging

Bolt Lock packaging: 1unit per box, 30pcs per carton,
Carton size : 54.5*20*30.5cm , Gross Weight :12kg. 50 cartons per pallet



You may need





ACM-Y130

Standard Type electronic Stripe
(NC/NO) For Wooden Door, Metal
Door,PVC Door

ACM-Y131

Stainless steel electronic Stripe
(NC/NO) For Wooden Door, Metal
Door,PVC Door

ACM-Y132

280kg(600lbs) Single Door magnetic
Lock Suitable For: Wooden Door, Glass
Door, Metal Door, Fire Proof Door.



ACM-Y280

Surface mounted magnetic
lock(280kg/600lbs)

ACM-Y100S

ELECTRIC DROP BOLT LOCK
Time-delay &NO/NC Power to unlock

ACM-Y066

Intelligent Smart Lock (motor lock)
Lock size: 130x98x41mm Working

Our Service

- 1, Any inquires will be replied within 24 hours
- 2, Professional manufacturer and supplier, Welcome to visit our website and our factory
- 3, OEM/ODM Available
- 4, High quality, fashin desing, reasonable & competitive price, fast lead time
- 5, After-sale Service :
 - 1), All products will have been strictly quality checked in house before packing
 - 2), All products will be well packed before shipping
 - 3), All our products have 2-3 year warranty if the damage is not caused by human
- 6, Faster delivery : Around 1~ 5 days for sample order, 7~30 days for bulk order
- 7, Payment : You can pay for the order via : T/T, Western Union, Paypal.
- 8, Shipping: We have strong cooperation with DHL, FEDEX, TNT, UPS, EMS, Forwarder by SEA and By AIR, You also can choose your own shipping forwarder.

FAQ

Q: 1. How can I place an order?

A: Please list your requirement to us via email. Then we will send the offer to you at earliest time,after order confirmation, we will arrange production ASAP.

Q: 2.What about the payment and shipment?

A: Trade Assurance and T/T ,Paypal, Western Union.
Clients can choose by sea, air or express(DHL, FedEx, TNT UPS etc.)

Q: 3. How can i get a sample to check your quality?

A:We could provide free sample to you, and the freight cost payed by you.

Q:4. How long can I expect to get the samples?

A: It depends on the quantity. Normally 3-7 days for 5000pcs and 7-15 days for 100,000pcs

Q:5. Can your products be customized?

A: Almost all of your products are customized ,including the materia, size, thickness and printing. OEM orders are highly welcome.

Q:6.Are you a trading company or factory?

We are the one of the biggest manufacturer of RFID cards/NFC tags/RFID keybod /RFID wristband□rfid reader and access control products in China more than 20 years.